

● Characteristics

0420 - OPTOELRKTRO - LEVEL SCAN

	- Measuring range	up to 4000 mm
	- Accuracy	± 3 mm
	- Tank geometry	standard formats + 20 measuring points
	- Sampling rate	1 Hz
	- Output	4... 20 mA
	- Supply	8... 33 VDC
	- Workspace	- 20... 80 °C
	- Settings	fixed measuring ranges
	- Material	Polycarbonate / NBR gasket
	- Protection Class	IP68
	- Dimensions	Ø 66 x 31 mm

● Specifications

Entrance

Level	0... 4000 mm
Medium	no surface contact necessary, even aggressive media possible

Output

Current signal	4... 20 mA
Resolution	0.01 mA

Performance Parameters

Measuring range	0... 4000 mm	
Consumption	< 70 mA / 12 V or < 40 mA / 24 V	
Scanning	1 Hz	
Accuracy	30 mm	2 mm in good measurement conditions
Resolution	1 mm	
Possible tank formats	standard irregular tank geometries possible, up to 20 programmable measuring points	
Laser class 1	~ 920 nm (frequency outside of any eye damage)	
Blind spot	30 mm	
Filter	non-static tank situations possible	

● Applications

Thanks to the low-power laser technology, the level sensor is a high-precision level measurement instrument. Non-contact measurement and the robust housing design enable more aggressive measurement environments without the usual material wear.



● Technical data (continued)

Environmental Conditions

Workspace	-20... 80 °C
Storage	-20... 80 °C
Measurement situation	industrial, static, moving, irregular tank shapes

Supply

Bus bar	8... 33 VDC reverse polarity protection
---------	--



Two types of accessory cables, sold separately:

1 m PVC 4-Pin sensor cable with M12 female connector

3 m PVC 4-Pin sensor cable with M12 female connector

Connection diagram M12 female connector:



Configuration

Technology	in fixed measuring ranges, fixed (see order code)
------------	---

Certifications

CE; Laser class 1; ISO 16750-2

● **Mechanics**

Dimensions	241.7 (total length over housing, cable, connector) x Ø 66 x 31 (height) mm	
Case	Polycarbonate	
Class	IP68	
Mechanical connection	SAE 5 hole (standard) max. built-in recess	4 hole adapter (accessories) 47.8 mm
Cable	150 mm	
Plug	M12 4-Pin female	

Installation diagram

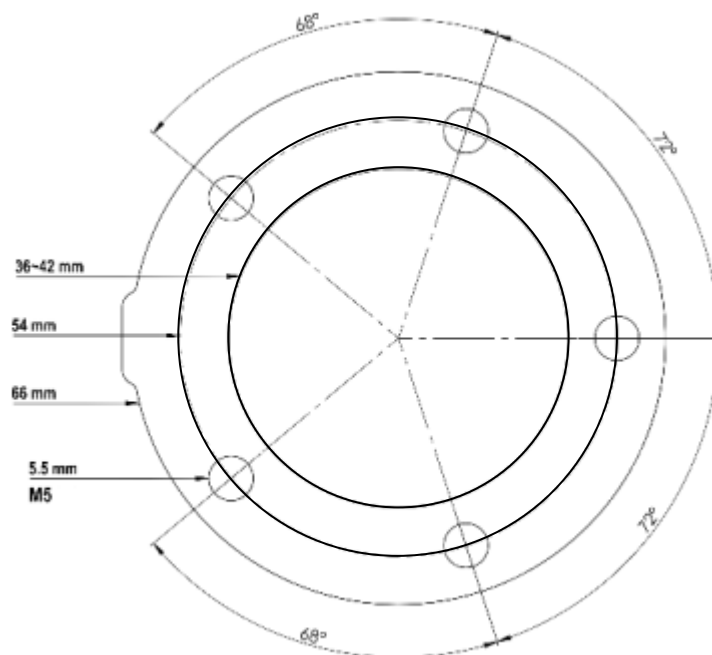

Installation diagram 5- to 4-bolt adapter (accessory)

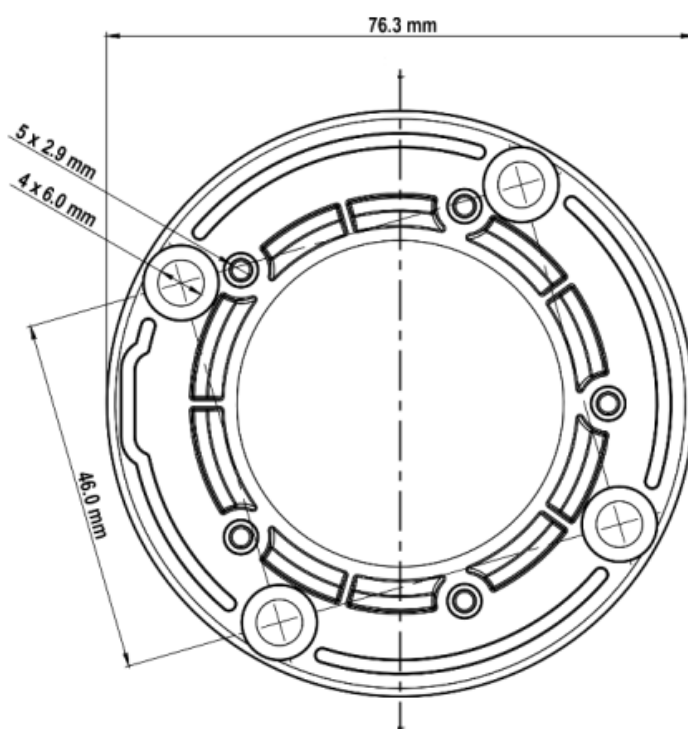

● **Order key**

F	T	X	X	X	X	-	X	-	X	X	X	X
----------	----------	----------	----------	----------	----------	----------	----------	----------	----------	----------	----------	----------

Measuring range	0... 4000 mm	0										
	0... 3000 mm	1										
	0... 2000 mm	2										
	custom	3										
Output	4... 20 mA	0										
Resolution	0.01 mA	0										
Laser class 1	~ 920 nm	0										
Accessory cable	without	0										
	1 m	1										
	3 m	2										
4-Hole adapter	without	0										
	with	1										
Resolution	3 mm	0										
Protection	IP68	0										
Configuration	factory	0										
	customized (please specify)	1										

Hint: Missing information when ordering will lead to delays.