

MOBEYE PRODUCTS



mobeye[®]
security. anywhere. anytime.

Introduction

Mobeye is a Dutch manufacturer of GSM alarm and security products. Mobeye is specialised in innovative GSM alarm and telemetry technology with a focus on an extremely low power consumption. The products have functions in the field of measuring, reporting, controlling and logging.

With an in-house development department, Mobeye continuously works on innovations, based on social developments and market needs.

Mobeye products focus on safety and comfort by remote monitoring of properties, valuables and appliances. The products are used worldwide in various sectors, including by police, industry, professional users and consumers.

In this brochure you will find the list of Mobeye alarm and monitoring products, followed by the information sheets.

Our team is happy to help you with any question about Mobeye products and customer-specific solutions.

Product groups	• alarm diallers
	• intruder
	• temperature
	• power failure) alarm
	• water
	• analogue
	• fire and panic
	• access control

MOBEYE PRODUCTS

	Article	Description
Alarm diallers I/O		
	CM4000	Mobeye CM-Guard
	MS100E	Mobeye Measure, Control and Alarm module
	MS100EK	Mobeye Measure, Control and Alarm module
	MS100B	Mobeye Measure, Control and Alarm module
	MS100BK	Mobeye Measure, Control and Alarm module
Intruder		
	i110	Mobeye i110
	i200	Mobeye Argos
	CMVXI-R	Mobeye Outdoor alarm
Temperature		
	CM4200	Mobeye ThermoGuard
	CM4200X	Mobeye ThermoGuard Outdoor*
	CML4255	Mobeye ThermoGuard-TwinLog*
	CML4275	Mobeye ThermoGuard-TwinLog*
	CML2285	Mobeye ThermoGuard-TwinLog*
Power (failure)		
	CM4100	Mobeye PowerGuard (EU)
	CM4100-UK	Mobeye PowerGuard (UK)
Multi sensor		
	CM4600	Mobeye CombiGuard / ShipGuard*
Water		
	CM4300	Mobeye WaterGuard
	CM4300FS	Mobeye WaterGuard-FS
	MS300	Mobeye Water Detector
Analogue		
	CML4015-P2	Mobeye SISTM Pulse/NO/NC*
	CML4015-V2	Mobeye SISTM 0-10V/NO/NC*
	CML4055	Mobeye CM-Guard TwinLog*
Fire		
	CM4400	Mobeye GSM Smoke Detector
	CM4400-RF	Mobeye GSM Smoke Detector incl. RF Ei650M
	CM4400H	Mobeye GSM Heat Detector
	CM4400H-RF	Mobeye GSM Heat Detector incl. RF Ei650M
	CM4410	Mobeye GSM Fire alarm communicator
Panic		
	CM4500	Mobeye Panic Button
Access control		
	MCK100	Mobeye Call-Key

* planned for Q3/Q4 2021, up to then CM2/CML2 version

MOBEYE ACCESSORIES

Accessories	Article	Description
	10027	Adapter, 12VDC (500mA), EU
	10131	Adapter , 12VDC (500mA), UK
	10174	Adapter , 12VDC (500mA), USA
	CR123	CR123 battery, 3.0V Lithium
	AC-BP3	Battery pack (±2 years), lithium (for CMVXI-R, CML4015, CML4275, CML4285)
	AC-BP5	Battery pack (±5 years), lithium in enclosure (for CML4015, CML4275, CML4285)
	AC-BPR-LI	Lithium Ion rechargeable battery pack for MS100E(K)
	AC-MC-S1	Magnet contact – surface
	MPIR-LP	PIR movement sensor, low power, wired, incl. 1* CR123
	AC-CMHX4	CM4 outdoor enclosure IP66
	AC-WS-LS1	Water leakage sensor for CM4300/CM4600
	AC-WS-FS1	Water float sensor for NO/NC inputs
	AC-TS-E1	Temperature sensor, 1 meter cable
	AC-TS-E2	Temperature sensor, 10 meter cable l
	AC-EC1	Extension cable 3m round for leakage/temperature sensor
	AC-EC2	Extension cable 1m flat for leakage/temperature sensor
	AC-EC3	Extension cable 10m round for leakage/temperature sensor
	AC-TAG1	Tag for CMVXI-R
	AC-AN-MBKS	Antenna kit LTE-M/GSM, stick, 13cm
	AC-AN-MBK30	Antenna kit LTE-M/GSM, disc, 30cm cable
	AC-AN-MBK250	Antenna kit LTE-M/GSM, disc, 250cm cable
	AC-AN-MBK10m	Antenna kit LTE-M/GSM, disc, 10m cable
	Ei650-RF	Ei Electronics smoke detector 10 yrs, incl. RF
	Ei603TYC-RF	Ei Electronics heat detector 10 yrs, incl. RF
	Ei428RF	Ei Electronics relays basis 230V/10 yrs backup incl. RF



Fully in control with the Mobeye alarm dialer

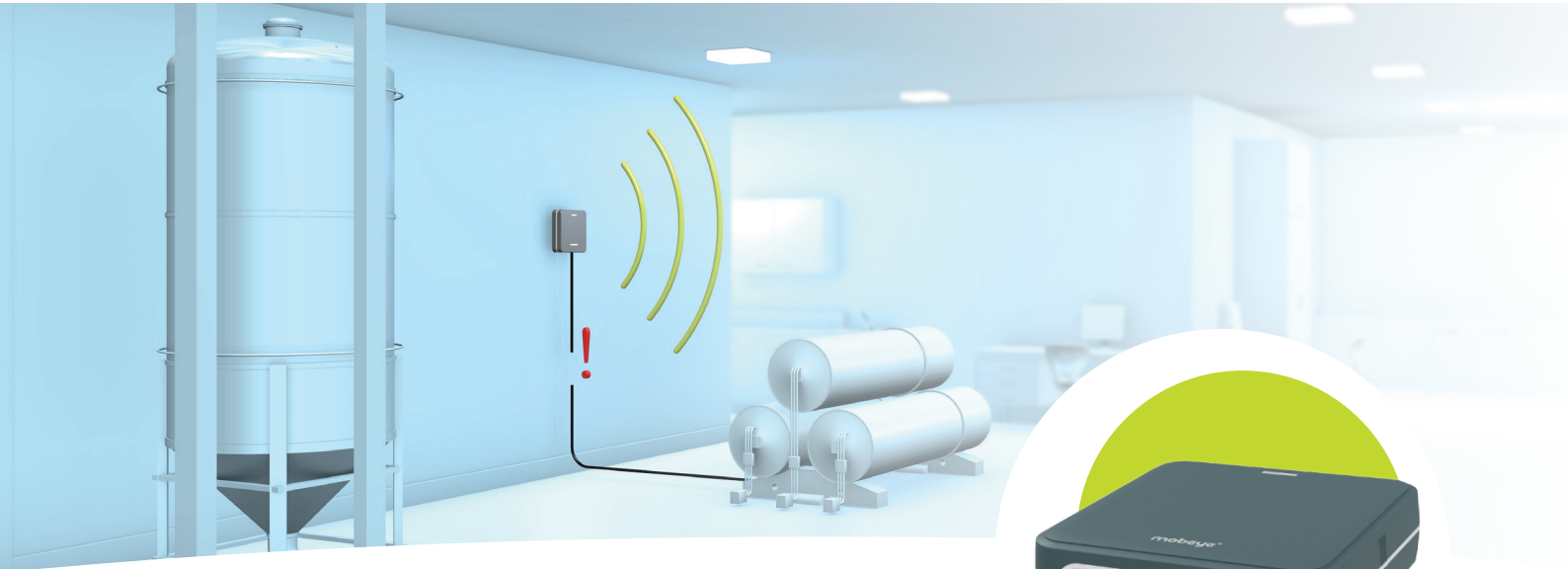

CM4000

Mobeye CM-Guard

The Mobeye CM-Guard is the control unit and alarm dialer for monitoring any technical installation. Universal, reliable and compact. Sensors and contacts are easily connected to the inputs. The device is fully battery powered, or uses external power. The built-in communication module can connect to the 4G LTE-M and the 2G network.

If one of the inputs indicates an alarm status, the CM-Guard alerts with a push notification, telephone call, SMS and/or e-mail. The contact persons can be set, with multiple options for the alarm message. Reporting to a control room (ARC) is also possible.

The Mobeye CM-Guard runs for more than a year on a set of batteries. Once the battery voltage is low, a message is sent. When using an external power source (12-24V DC or mains), it also sends "power failure" notifications; this is often the first indication that something is wrong on the spot.

The set-up is ready in a few simple steps. The compact box may be used as a free-standing unit or the mounting holes may be used to hang it.



Mobeye CM-Guard, universal alarm dialer

Any potential-free sensor may be connected. The CM-Guard has various setting options, such as automatic switch-on and switch-off times, alarm texts per input, alarm delay, alarm restore messages, repeat notifications and test messages. The batteries are included.

security. anywhere. anytime.

CM4000 Mobeye CM-Guard



HOW IT WORKS



The Mobeye CM4000 monitors your installation remotely. The alarm device immediately sends a notification when the status changes. In this way you have full control.

- 1 Attach a potential-free contact to one of the inputs of the CM-Guard. This may be a fault signal from an installation, or a sensor with make/break contact.
- 2 The CM-Guard detects any status change on the inputs. When connected to external power, it also signals a power failure.
- 3 In an alarm situation, the CM-Guard sends alarm messages to the contact persons. When using the portal and app, an escalation plan including alarm confirmation can be set.

Mobeye SIM, Portal & App service

The Mobeye Internet Portal offers a clear dashboard and essential functions, such as push notifications per app, online programming, setting up the notifications, insight into the status and history, network strength, events and position (Cell-Id). The 'keep-alive' monitor offers extra security by monitoring the receipt of test messages. You can activate the supplied Mobeye SIM card online.

CM4000 - Technical data

Contents	<ul style="list-style-type: none">CM4000, 2x CR123 batteries, SIM card
(Alarm) messages	<ul style="list-style-type: none">input alarm, power failure, alarm recovery, battery low voltage, (missed) test reportto private contacts via app, call, text message and/or e-mail, or to a control room (ARC)
Reporting	<ul style="list-style-type: none">status, setting list, event history, network strength and position based on Cell ID
Setting options	<ul style="list-style-type: none">contacts (unlimited number) for alarm and service messages, message texts, repeat cycles, input type normally open or normally closed, recovery messages, alarm delay times, test interval (keep-alive), ARC, etc.
Operation	<ul style="list-style-type: none">arming and disarming via button, time schedules and SMS
Inputs	<ul style="list-style-type: none">2x NO/NC input (potential-free), 1x 12-24V DC (+/- 2V)
Power supply	<ul style="list-style-type: none">2x CR123 lithium batteries or 12-24V DC (regulated) + 2x CR123 lithium
Battery lifetime	<ul style="list-style-type: none">> 1 year at normal use (battery operated), > 3 years at normal use (powered externally)
Dimensions	<ul style="list-style-type: none">94 x 94 x 28 mm
Connectivity	<ul style="list-style-type: none">4G LTE-M (worldwide) + 2G EGSM Quad band the Mobeye SIM card and Internet Portal provide full functionality and optimum security. The 4G LTE-M network is very reliable and ensures a strong penetration against low energy consumption. 2G is available as a fallback2G EGSM Quad band (850/900/1800/1900 MHz) when using your own SIM card, the device works (only) on 2G. The operation is "stand-alone", without using the Mobeye Portal. The alarm notifications are sent via SMS and telephone call to (max.) 5 contacts. Programming is done via (simple) SMS commands
Accessories (not included)	<ul style="list-style-type: none">mains adapter, external antenna

Mobeye is specialised in high-quality 2G/4G/LoRa alarm and telemetry technology. Visit mobeye.com for more information about our technology, applications and detailed product information.

security. anywhere. anytime.



Always informed about power failure and malfunctions



CM4100 Mobeye PowerGuard

The Mobeye PowerGuard is the power failure monitor and fault detector with versatile applications. Understandable, reliable and compact. The power source is monitored by plugging the power adapter into a power outlet. In addition, sensors and contacts may be connected to the alarm inputs. The built-in communication module can connect to the 4G LTE-M and the 2G network.

In the event of a power failure or an input alarm, the PowerGuard alerts with a push notification, telephone call, SMS and/or e-mail. The contact persons can be set, with multiple options for the alarm message. Reporting to a control room (ARC) is possible.

The Mobeye PowerGuard monitors the mains power or a 12-24V DC power source. In the event of an outage, it uses the batteries to send the notifications and continuously monitor the inputs. After the power is restored, the contacts receive a recovery notification.

The set-up is ready in a few simple steps. The PowerGuard box may be placed as free-standing unit or the mounting holes may be used to hang it on a wall.



Mobeye PowerGuard, a powerful monitoring device

The PowerGuard has various setting options, such as automatic switch-on and switch-off times, alarm texts per input, alarm delay, recovery messages, repeat notifications, test messages. The batteries and (country specific) mains adapter are included.

CM4100 Mobeye PowerGuard



HOW IT WORKS



The Mobeye CM4100 monitors the availability of the external power and the status of connected fault contacts. The alarm dialer immediately sends a notification when the status changes. This means you are always well informed.

- 1 Plug the mains adapter into a wall socket and, if desired, attach a potential-free sensor to one of the inputs.
- 2 The PowerGuard recognises power failure and an input alarm.
- 3 In an alarm situation, the PowerGuard sends alarm messages to the contacts. When using the portal and app, an escalation plan including alarm confirmation can be set.

Mobeye SIM, Portal & App service

The Mobeye Internet Portal offers a clear dashboard and essential functions, such as push notifications per app, online programming, setting up the notifications, insight into the status and history, network strength, events and position (Cell-Id). The 'keep-alive' monitor offers extra security by monitoring the receipt of test messages. You can activate the supplied Mobeye SIM card online.

CM4100 - Technical data

Contents	<ul style="list-style-type: none"> CM4100, mains adapter (country specific version), 2x CR123 batteries, SIM card
(Alarm) messages	<ul style="list-style-type: none"> power failure, input alarm, alarm recovery, battery low voltage, (missed) test report to private contacts via app, call, text message and/or e-mail, or to a control room (ARC)
Reporting	<ul style="list-style-type: none"> status, setting list, event history, network strength and position based on Cell ID
Setting options	<ul style="list-style-type: none"> contacts (unlimited number) for alarm and service messages, message texts, repeat cycles, input type normally open or normally closed, recovery messages, alarm delay times, test interval (keep-alive), ARC, etc.
Operation	<ul style="list-style-type: none"> arming and disarming via button, time schedules and SMS
Inputs	<ul style="list-style-type: none"> 2x NO/NC input (potential-free), 1x 12-24V DC (+/- 2V)
Power supply	<ul style="list-style-type: none"> 2x CR123 lithium batteries or 12-24V DC (regulated) + 2x CR123 lithium
Battery lifetime	<ul style="list-style-type: none"> > 3 years at normal use (powered externally), > 1 year at normal use (battery operated)
Dimensions	<ul style="list-style-type: none"> 94 x 94 x 28 mm
Connectivity	<ul style="list-style-type: none"> 4G LTE-M (worldwide) + 2G EGSM Quad band the Mobeye SIM card and Internet Portal provide full functionality and optimum security. The 4G LTE-M network is very reliable and ensures a strong penetration against low energy consumption 2G is available as a fallback 2G EGSM Quad band (850/900/1800/1900 MHz) when using your own SIM card, the device works (only) on 2G. The operation is "stand-alone", without using the Mobeye Portal. The alarm notifications are sent via SMS and telephone call to (max.) 5 contacts. Programming is done via (simple) SMS commands
Accessories (not included)	<ul style="list-style-type: none"> external antenna

Mobeye is specialised in high-quality 2G/4G/LoRa alarm and telemetry technology. Visit mobeye.com for more information about our technology, applications and detailed product information.

security. anywhere. anytime.

MOBEYE

Measure, Control and Alarm Modules



Mobeye MS100E, MS100B, MS100EK, MS100BK

GSM telemetry and alarm module for professionals

Powerful telemetry modules in four models with internal GSM module, digital inputs, relay outputs and a multitude of settings. Build your own alarm module with sensors, devices and alarms.

Activated inputs trigger an alarm. The output relays can be switched after an alarm, or remotely by an incoming call or SMS. It is a user option to switch the relays completely or only during a pulse time. The built-in GSM module calls and sends SMS messages to the contact persons (max. 5).

Flexible action and reaction patterns

The behaviour of the Mobeye telemetry modules is programmable via the keypad or using simple SMS commands. By adjusting the action-reaction patterns, the behaviour of the inputs, outputs and the GSM unit is flexible can be set up according to your preferences.

Options

- input type (NO/NC), free texts per alarm input, delay times
- inactive time after an alarm, alarm repeat times
- choice between calls and/or SMS after an alarm
- behaviour and pulse time of outputs
- authorising numbers for switching the outputs
- time-based actions, interval for test reports

External power or 'low power' operation

The MS100E and MS100EK operate at 9-32 VDC power, with optional a rechargeable battery pack. Upon failure of power, the GSM module remains open and remote operation possible.

The MS100B and MS100BK are designed for continuous use on batteries. With only battery power they monitor the inputs and to notify in case of an alarm condition; remote control is not possible in this low power mode.

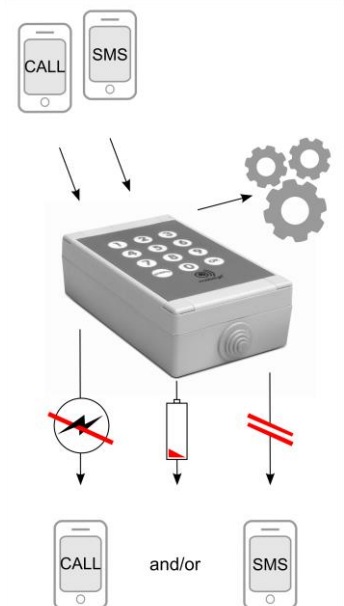

Fields of application

The GSM telemetry modules in the MS100 series are powerful measure, control and alarm modules which are ready-to-use thanks to the default settings. For advanced system integrators they offer extensive customization options. The modules are suitable for many measure, control and alarm applications in the industry, agricultural, medical, construction, automotive and marine branch.



MS100 MODULES	product	keypad	Power supply	options
	MS100E	no	9-32 VDC	mains adapter, rechargeable battery pack
	MS100B	no	4 batteries (CR123)	9-32VDC power or mains adapter
	MS100EK	yes	9-32 VDC	mains adapter, rechargeable battery pack
	MS100BK	yes	4 batteries (CR123)	9-32VDC power or mains adapter

Mobeye MS100 Technical data	
User interface	<ul style="list-style-type: none"> • keypad • SMS / call
Inputs/outputs	<ul style="list-style-type: none"> • 2 inputs, dry contact (NO, NC) • 2 outputs (max. 30V/2A)
(Alarm) messages	<ul style="list-style-type: none"> • SMS and/or call after triggered input • SMS and/or call after power failure / power restoration • SMS after low batteries • SMS test messages ("keep alive")
Output control	<ul style="list-style-type: none"> • triggered by activated inputs • triggered by incoming SMS text message or call
Reports	<ul style="list-style-type: none"> • status reports and settings report via SMS text message
GSM connection	<ul style="list-style-type: none"> • using external power, the GSM is open to receive commands for remote control
Security Configuration	<ul style="list-style-type: none"> • PIN code security for configuration • via keypad and SMS <ul style="list-style-type: none"> • telephone numbers (max. 5), authorising numbers for switching the outputs (max. 10) • input type NO or NC • identification and alarm texts • action-reaction patterns for (alarm) messages. <ul style="list-style-type: none"> possible triggers (actions): activated input, power restore, time-based, incoming call/SMS. reactions: call, SMS message, controlling output. • alarm delays times, alarm repeat times, inactive times after an alarm • interval test messages
Dimensions	<ul style="list-style-type: none"> • 145x90x45 mm
GSM/GPRS	<ul style="list-style-type: none"> • quad band EGSM 900/1800 - 850/1900 MHz
Ambient temperature	<ul style="list-style-type: none"> • -10° C ... 55° C (in case of low temperatures the battery life time is shortened)

About Mobeye

The Dutch company Mobeye is specialized in high quality GSM/GPRS alarm and telemetry technology. Mobeye products are characterised by configuration flexibility, user friendliness and an extremely low power consumption. Mobeye aims to design and market products that contribute to a safer world for its customers.

The compact GSM Alarm system.

Anywhere, anytime.

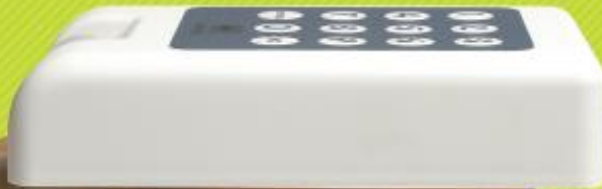

mobeye®



Mobeye i110

How it works



GSM alarm system

The Mobeye i110 responds to movements. As soon as an intruder is seen, the system sends an SMS text message and calls the set numbers. Burglars have no chance.



Temperature alarm

The Mobeye i110 is also a temperature alarm system. It sends an alarm message as soon as the temperature gets out-of-range.



Alarming

In case of an alarm the Mobeye i110 will call and SMS to the (max. 2) set numbers. First place a SIM card from any provider.



Battery powered

The Mobeye i110 is extremely energy efficient and can run for more than a year on a set of batteries. You will receive an SMS text message if these need to be replaced.

The all-in-one GSM alarm system

Security is now possible in places where first it was not: places without power supply or in situations where installation work is not appreciated.

- The Mobeye i110 is unique in its kind. It is an all-in-one alarm system, with its own power supply.
- The Mobeye i110 is characterised by simplicity. installation work not necessary.
- No separate accessories, no power cables. It includes a motion detector, temperature sensor and a GSM module. Battery life is sustained for over one year.

Mobile alarm

The Mobeye alarm system is ideally suited for places lacking power supply. You can easily affix the small box to a wall or just lay it down. The installation for basic operation takes only a few steps.

The Mobeye alarm system can be applied in a flexible manner. For your boat in the harbour, or in the garage box where you store many things of value. The shed at the back of the garden. In your house under construction, where the kitchen has just been placed. Or as security in your empty (holiday) home. The Mobeye is also ideal for use in risky properties or temporary protection.

Mobeye i110



The various alarms

- Motion alarm via built-in movement detector (PIR)
- Temperature alarm via built-in sensor

Response after an alarm

- SMS and/or call to (max.2) numbers
- Option for silent or loud entry delay
- Option for silent or loud alarm

Programming

- Via keypad or SMS commands
- Adjustable programming code
- User-defined recognition and alarm texts
- Adjustable sensor sensitivity
- Test messages with an adjustable interval
- Adjustable minimum and maximum temperature

Switching on and off

- Via programming code or personal (arm and disarm) code

Battery operated

- Fully autonomous operation when battery powered
- Battery life > 1 year (even in case of a daily report)
- "battery low" SMS notification for low battery voltage

Reports and overviews

- Setting and status lists by SMS text message
- Sensor test to determine the best position
- Test function to measure the GSM signal strength

When connected to the Mobeye Internet Portal

- Forwarding of alarm messages via SMS and e-mail
- Linking of name/address on the internet, this identification name is included in dispatched messages via the portal
- Historical (log) data
- Monitoring of test messages ("keep-alive"), SMS/e-mail reports in case of a missed message

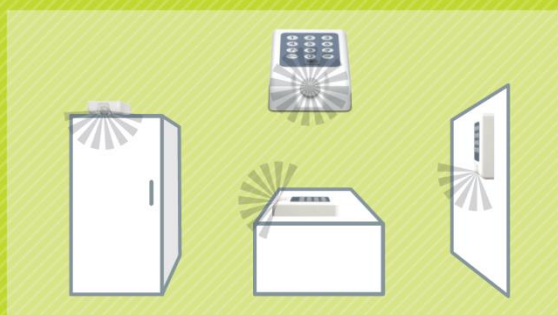

Mobeye i110 Detection area

The Mobeye® i110 can be positioned on a wall or simply on a table. The movement detector overlooks a distance of about 10 meter, 360 degrees circular. The shape of the casing allows you to choose the angle at which you want to observe movements.

Mobeye i110 Specifications

Dimensions	90 x 161 x 35 (mm)
Power supply	4 * lithium 3V batteries
Battery life time	> 1 year
Power	< 50 microA
Detection range	ca. 8 meter
Temperature	-10 until +50 degrees Celsius
GSM/GPRS	Quad band EGSM 900/1800 – 850/1900MHz

About Mobeye

The company Mobeye is specialized in high quality GSM/ alarm and telemetry technology. Mobeye products are characterised by configuration flexibility, user friendliness and an extremely low power consumption. Mobeye aims to design and market products that contribute to a safer world for its customers.



GSM alarm system

The Mobeye Argos responds to movements. As soon as an intruder is seen, the system sends an SMS text message and calls the set numbers. Burglars have no chance.



Temperature alarm

The Mobeye Argos is also a temperature alarm system. It sends an alarm message as soon as the temperature gets out-of-range.



Alarming

In case of an alarm the Mobeye Argos will call and SMS to the (up to 5) set numbers. As soon as somebody 'confirms' the alarm, the system will not alarm the others.



Battery powered

The Mobeye Argos is extremely energy efficient and can run for more than a year on a set of batteries. You will receive an SMS text message if these need to be replaced.



Listen-in

Upon an alarm you can listen-in to what is happening on site. When hearing sounds or unknown voices, take immediate action like warning the neighbors or calling the police.



Time-based actions

Arming and disarming can be done by entering the personal code. Additionally, various actions can be preset to take place at specific times.



Additional sensors

Additional sensors can be connected to the two inputs, like a magnetic contact or an additional motion sensor. Devices can be controlled via the outputs after an alarm, time-based or (using external power) via a mobile phone.



The Mobeye Internet Portal

Optionally, the Mobeye Argos can be connected to the web-based portal to forward (alarm) messages to additional numbers and mail accounts. The portal also monitors 'keep-alive' messages.

MOBEYE ARGOS

The complete GSM alarm system

The Mobeye GSM alarm system is easy, reliable and complete. The ideal system for places without power, small locations and temporary security.

Safe and easy

Place the alarm where monitoring is required and enter the code. You can now calmly leave the room. After a minute, the movement detector is armed and will detect every movement. If the system is not disarmed within the entrance delay time, the system will call and SMS to the preset phone numbers.

Self-contained

The system operates completely independently using the integrated movement detector, temperature sensor, GSM dialer and batteries.

The installation for basic operation takes only a few steps. The Mobeye Argos offers many options, such as a listen-in function, temperature alarm, time-based actions, additional sensors and various alarm inputs. The various alarm sensors can be enabled simultaneously and independently.

MOBEYE ARGOS



The various alarms

- motion alarm via built-in movement detector (PIR)
- alarm after activation of sensors connected to the inputs
- temperature alarm via built-in sensor

Response after an alarm

- SMS and/or call to (max. 5) numbers
- listen-in function after motion alarm
- confirmation of alarm via phone (DTMF)
- option for silent or loud entry delay
- option for silent or loud alarm

Programming

- via keypad or SMS commands
- adjustable programming code
- user-defined recognition and alarm texts
- adjustable sensor sensitivity
- test messages with an adjustable interval
- adjustable minimum and maximum temperature

Switching on and off

- via programming code or personal (arm and disarm) code
- adjustable time-based arming and disarming

Reports and overviews

- setting and status lists by SMS text message
- sensor test to determine the best position
- test function to measure the GSM signal strength
- jamming detection to be reported after signal returns

When battery operated

- fully autonomous operation when battery powered
- battery life > 1 year (even in case of a daily report)
- "battery low" SMS notification for low battery voltage

When connected to external power supply

- arming and disarming by SMS command
- controlling the output relays by SMS command or call
- power failure notification/power restoration notification
- batteries as back-up power supply
- battery life time > 2 years
- "battery low" SMS notification for low battery voltage

Additional inputs and outputs

- 2 (NO/NC) inputs for additional sensors
- 2 relay outputs (max. 2A/30V)
- magnetic contact, (low power) PIR and water float sensor as accessory

When connected to the Mobeye Internet Portal

- forwarding of alarm messages via SMS and e-mail
- linking of name/address on the internet, this identification name is included in dispatched messages via the portal
- historical (log) data
- monitoring of test messages ('keep-alive'), SMS/e-mail reports in case of a missed message

Mobeye Argos i200 Specifications

Dimensions	90 x 161 x 35 (mm)
Power supply	4 * lithium 3V batteries, optional 9-24 VDC adapter
Battery life time	> 1 year
Power	< 50 microA
Detection range	ca. 8 meter
Temperature	-10 until +50 degrees Celsius
GSM/GPRS	Quad band EGSM 900/1800 – 850/1900MHz

Over Mobeye

The company Mobeye is specialized in high quality GSM alarm and telemetry technology. Mobeye products are characterised by configuration flexibility, user friendliness and an extremely low power consumption. Mobeye aims to design and market products that contribute to a safer world for its customers.

MOBEYE

Outdoor Alarm

Mobeye CMVXI-R



Simple, reliable and effective site security

The Mobeye Outdoor Alarm is a stand-alone external GSM PIR Alarm that combines the reliable Optex VX-Infinity dual-optic (PIR) detector and low power Mobeye GSM technology. The Mobeye CMVXI-R is ideal for temporary protection and places where no electricity or telephone lines are available. The system can be attached to a wall, a pole, or even to a tree.

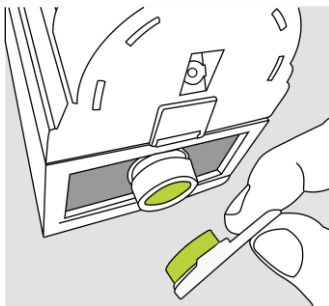

- silent alarm
- alerts via SMS text / phone call / e-mail / ARC
- arming and disarming via i-Button fob (included)
- arming and disarming automatically using in-built timer functions
- battery life time about 2,5 years
- low battery warning

Detection and signalling

The CMVXI-R is based on the market leading external PIR from Optex, the world leaders in PIR technology. The unit has two detection patterns, both of which must be broken simultaneously in order to trigger the alarm. This results in the detector being highly immune to false alarms created by birds, cats, dogs etc. as these animals will not trigger both the top and bottom detectors at the same time.

Once movement of a human sized object is detected, the GSM module switches on. The alarm notification is sent to the pre-programmed numbers as an SMS text message, a phone call and/or e-mail.



Alarm when both upper and lower detection area are blocked.



No alarm when only the lower (or upper) detection area is blocked.



Response after an intruder alarm

- SMS and/or call to (max. 5) numbers
- In combination with the Mobeye Internet Portal
 - SMS text / e-mail to unlimited number of contacts, phone call to (max. 5) numbers
 - SIA/DC09 message to ARC

Switching on and off

- automatically based on timer function (2 schedules)
- via tag, confirmation by light and sound
- enrollment of additional tags (max. 25)

Battery operated

- fully autonomous operation when battery powered
- battery life: 2 - 2,5 years
- "battery low" SMS notification for low battery voltage

Programming, reports and overviews

- per sms text message: alarm texts, test messages with an adjustable interval ('keep alive'), status and settings lists, reports of strength of GSM network
- In combination with the Mobeye Internet Portal
 - online programming and management of devices
 - user friendly user interface, for mobile phone and PC
 - forwarding of alarm messages via call, SMS and/or e-mail
 - differentiation between 'alarm' and 'service' contact persons
 - historical (log) data of arming/disarming times and events
 - display of position at last event based on cell-ID
 - automated monitoring of test messages (exception messages)

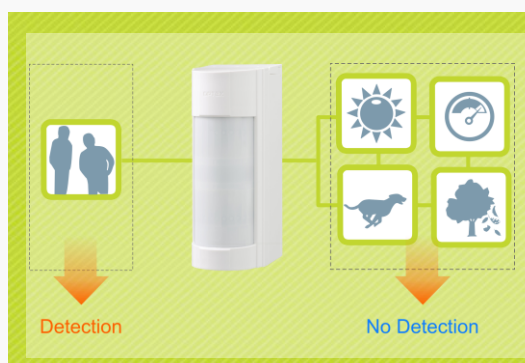

Digital Double Layer Detection

The two internal PIR sensors independently analyze the detection so that a misleading coincidence of events can be filtered out. This technology virtually eliminates detections of smaller animals in the premises. The VXI-R model is equipped with a digitally enhanced signal recognition logic called SMDA. SMDA improves immunity against various noise factors such as climate changes and vegetation sways.

Mobeye Outdoor Alarm CMVXI-R Technical Data

Detector	<ul style="list-style-type: none"> • Optex VXI-R; adjustable angle • 12 meter detection, 90° detection pattern (rotatable through 180°) • Distance adjustment: 2,5 – 12 m (5 levels of detection), 8 horizontal area positions
Installation	<ul style="list-style-type: none"> • at 0,8 ... 1,2 m height, mounting materials included
Dimensions & features	<ul style="list-style-type: none"> • 71 x 105 x 186 mm (w*l*h) • IP55 • Ambient temperature -10 ... 55 °C
GSM/GPRS	<ul style="list-style-type: none"> • Quad band EGSM 900/1800 - 850/1900 MHz
Product content	<ul style="list-style-type: none"> • Optex VXI-R, integrated GSM-module, tag reader • 2x CR123 batteries + 6x CR123 battery pack • 2 tags

About Mobeye

The company Mobeye is specialized in high quality GSM/3G/4G/LoRa alarm and telemetry technology. Mobeye products are characterised by configuration flexibility, user friendliness and an extremely low power consumption. Mobeye aims to design and market products that contribute to a safer world for its customers.



Call for help
at the touch of the button



CM4500

Mobeye Panic Button

The Mobeye Panic Alarm notifies contact persons after pressing the button. The panic button requires no wiring and runs on batteries for a long time. Compact and reliable. The box can be placed close to a person, under a desk, bed or near a machine. The built-in communication module can connect to the 4G LTE-M and the 2G network.

After the button has been pressed, the Panic Button alarms with a push message, telephone call, SMS and/or e-mail. The contact persons can be set, with multiple options for the alarm message. Reporting to an emergency room (ARC) is also possible.

The Mobeye Panic Alarm works for more than a year on a set of batteries. The response time is around 20-25 seconds. This time can be shortened by using an external power source (12-24V DC or mains voltage).

The set-up is ready in a few simple steps. The detector may be placed as free-standing unit or hung via the mounting holes.



Panic button for extra security

The button is located at the backside of the housing, ideal for operation from under a desk or bed. If a larger single touch button is required, an external button can be connected.

Typical applications are personal protection for lone workers, vulnerable people at home or as a safety measure for (store) staff.

security. anywhere. anytime.

CM4500 Mobeye Panic Button



HOW IT WORKS

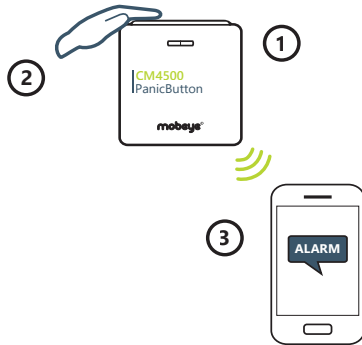

The Mobeye CM4500 alerts contacts after pressing the button. The panic alarm sends a notification to predefined contacts. This provides extra security in vulnerable situations.

- 1 The settings and contacts are prepared in a few steps. Fix the box in a place close to the person.
- 2 After pressing the button, the communicator will react immediately and send the alarm messages.
- 3 The contacts are informed by telephone with a predefined alarm text. When using the portal and app, an escalation plan including alarm confirmation can be set.

Mobeye SIM, Portal & App service

The Mobeye Internet Portal offers a clear dashboard and essential functions, such as push notifications per app, online programming, setting up the notifications, insight into the status and history, network strength, events and position (Cell-Id). The 'keep-alive' monitor offers extra security by monitoring the receipt of test messages. You can activate the supplied Mobeye SIM card online.

CM4500 - Technical data

Contents	<ul style="list-style-type: none"> CM4500, 2x CR123 batteries, SIM card
(Alarm) messages	<ul style="list-style-type: none"> panic alarm, power failure, battery low voltage, (missed) test report to private contacts via app, call, text message and/or e-mail, or to a control room (ARC)
Reporting	<ul style="list-style-type: none"> status, setting list, event history, network strength and position based on Cell ID
Setting options	<ul style="list-style-type: none"> contacts (unlimited number) for alarm and service messages, message texts, test interval (keep-alive), ARC, etc.
Inputs	<ul style="list-style-type: none"> push button, 2x NO/NC input (potential-free), 1x 12-24V DC (+/- 2V)
Power supply	<ul style="list-style-type: none"> 2x CR123 lithium batteries or 12-24V DC (regulated) + 2x CR123 lithium
Battery lifetime	<ul style="list-style-type: none"> > 1 year at normal use (battery operated), > 3 years at normal use (powered externally)
Dimensions	<ul style="list-style-type: none"> 94 x 94 x 28 mm
Connectivity	<ul style="list-style-type: none"> 4G LTE-M (worldwide) + 2G EGSM Quad band the Mobeye SIM card and Internet Portal provide full functionality and optimum security. The 4G LTE-M network is very reliable and ensures a strong penetration against low energy consumption. 2G is available as a fallback 2G EGSM Quad band (850/900/1800/1900 MHz) when using your own SIM card, the device works (only) on 2G. The operation is "stand-alone", without using the Mobeye Portal. The alarm notifications are sent via SMS and telephone call to (max.) 5 contacts. Programming is done via (simple) SMS commands
Accessories (not included)	<ul style="list-style-type: none"> mains adapter, external push button

Mobeye is specialised in high-quality 2G/4G/LoRa alarm and telemetry technology. Visit mobeye.com for more information about our technology, applications and detailed product information.

security. anywhere. anytime.

Monitoring of temperature limits alarm notification in case of deviations



CM4200

Mobeye ThermoGuard

The Mobeye ThermoGuard helps prevent damage from cold or overheating. By setting a lower and/or upper limit, this compact device monitors the ambient temperature. The ThermoGuard is equipped with a highly reliable temperature sensor. As soon as the temperature is outside the limits an alarm message will follow. The device is fully battery powered, or uses external power. The built-in communication module can connect to the 4G LTE-M and the 2G network.

If the temperature or one of the inputs indicate an alarm status, the ThermoGuard alerts with a push notification, telephone call, SMS and/or e-mail. The contact persons can be set, with multiple options for the alarm message. The messages also state the current temperature.

The Mobeye ThermoGuard runs for more than a year on a set of batteries. A message is sent when the battery voltage is low. When using an external power source (12-24V DC or mains), it also sends "power failure" notifications; this is often the first indication that something is wrong and an action is required.



Mobeye ThermoGuard, reliable and simple

Next to the temperature sensor, two potential-free sensors may be connected, for example a failure contact or door magnet contact. The settings are easy to program in, such as the temperature limits, automatic switch-on and switch-off times, alarm delay, calibration value, repeat notifications, test messages and alarm texts.

CM4200 Mobeye ThermoGuard



HOW IT WORKS



The Mobeye CM4200 continuously measures the temperature values. The alarm dialer immediately sends a notification if it gets too cold or too hot. In this way you have full control.

- 1 Place the sensor at a location with a stable temperature, not too close to the cooling element or heat source.
- 2 Set the temperature limits and choose contacts for the notifications.
- 3 As soon as the measured temperature is outside the set limits, the ThermoGuard sends alarm messages to the contacts. When using the portal and app, an escalation plan including alarm confirmation can be set.

Mobeye SIM, Portal & App service

The Mobeye Internet Portal offers a clear dashboard and essential functions, such as push notifications per app, online programming, setting up the notifications, insight into the status and history, network strength, events and position (Cell-Id). The 'keep-alive' monitor offers extra security by monitoring the receipt of test messages. You can activate the supplied Mobeye SIM card online.

CM4200 - Technical data

Contents	<ul style="list-style-type: none"> CM4200, 1x digital temperature sensor, 2x CR123 batteries, SIM card
(Alarm) messages	<ul style="list-style-type: none"> temperature alarm, input alarm, power failure, alarm recovery, battery low voltage, (missed) test report to private contacts via app, call, text message and/or e-mail
Reporting	<ul style="list-style-type: none"> temperature value, status, setting list, event history, network strength and position based on Cell ID
Setting options	<ul style="list-style-type: none"> temperature limits (between -35 ... +70 °C), contact persons (unlimited number) for alarm and service messages, message texts, repeat cycles, input type, recovery messages, alarm delay times, test interval (keep-alive), etc.
Operation	<ul style="list-style-type: none"> arming and disarming via button, time schedules and SMS
Temperature sensor	<ul style="list-style-type: none"> 1 meter cable accuracy: 0.5°C between -30 °C and +55 °C, 1 °C outside these limits
Inputs	<ul style="list-style-type: none"> 1x digital temperature input, 2x NO/NC input (potential-free), 1x 12-24V DC (+/- 2V)
Power supply	<ul style="list-style-type: none"> 2x CR123 lithium batteries or 12-24V DC (regulated) + 2x CR123 lithium
Battery lifetime	<ul style="list-style-type: none"> > 1 year at normal use (battery operated), > 3 years at normal use (powered externally)
Dimensions	<ul style="list-style-type: none"> 94 x 94 x 28 mm
Connectivity	<ul style="list-style-type: none"> 4G LTE-M (worldwide) + 2G EGSM Quad band the Mobeye SIM card and Internet Portal provide full functionality and optimum security. The 4G LTE-M network is very reliable and ensures a strong penetration against low energy consumption. 2G is available as a fallback 2G EGSM Quad band (850/900/1800/1900 MHz) when using your own SIM card, the device works (only) on 2G. The operation is "stand-alone", without using the Mobeye Portal. The alarm notifications are sent via SMS and telephone call to (max.) 5 contacts. Programming is done via (simple) SMS commands
Accessories (not included)	<ul style="list-style-type: none"> mains adapter, extension cable (3m, 10m, 1m flat cable), external antenna

Mobeye is specialised in high-quality 2G/4G/LoRa alarm and telemetry technology. Visit mobeye.com for more information about our technology, applications and detailed product information.

security. anywhere. anytime.

MOBEYE THERMOGUARD TWINLOG

CML2255



Log, Alarm and Report temperature values

Mobeye CML2255



Continuous measurement of ambient temperature.
Two temperature sensor inputs.



Alarm upon violation of user-defined (minimum/ maximum) temperature limits.



Logging of temperature values, synced in cloud-based portal. User-defined log and sync intervals.



Battery operated; battery lifetime >1 year at daily reporting.
Longer lifetime possible.



If powered externally, monitoring of the power source and alarming at power failure is possible.



Manual or time-based arming and disarming.



NO/NC inputs for additional alarm options, such as a 'door open' notification.



Internal piezo siren for alarm indication.
Additional output for activating an external device.

The Mobeye ThermoGuard TwinLog is a compact remote monitoring unit for reporting and logging of temperature values.

The digital temperature sensor(s) continuously measure the ambient temperature and compare the value(s) with the configured alarm limits. When the minimum and/or maximum temperature limits are violated, the CML2255 will send alarm notifications and a siren sounds. Optionally, the unit can log the measured temperatures and send it to the Mobeye Internet Portal where the data is shown in graphs and tables.

The CML2255 has an integrated GSM module and is designed to run on batteries. When powered by an externally source, it also serves as a power failure alarm.

Mobeye Internet Portal

After inserting a SIM card and a simple set-up, the CML2255 is ready for sending alarm notifications. Equipped with a Mobeye SIM card and registered on the Internet Portal, more functions are available:

- Logging of temperature values (user-defined intervals)
- Programming via portal
- Forwarding of messages to 'alarm contacts' and 'service contacts' (call/SMS/e-mail)
- Monitoring of 'keep alive' (test) messages

Mobeye CML2255



Alarm and alarm restore reports via call, SMS and e-mail*

- temperature alarm
- activated NO/NC input
- external power failure

Logging of temperature values*

- user-defined log interval
- user-defined data transfer interval (sync)
- historical values, status, download options

Notifications

- low internal battery voltage
- 'keep alive' message at user defined interval
- exception message if 'keep-alive' was not received timely*

Reports and status overviews

- actual temperature
- GSM signal strength
- position data at last event (cell-id)*

Options

- min. and/or max. measurement range, per sensor: -35 ... +70 °C
- 5 phone numbers
- alarm texts
- alarm delay times
- temperature calibration
- siren on/off

Arm and disarm

- time-based arming and disarming with two schedules

When battery operated

- fully autonomous operation when battery powered
- battery life > 1 year (with daily report)

* features in combination with the Mobeye Internet Portal

Mobeye CML2255 Technical Data

Content	• main unit with integrated GSM module, 1 external temperature sensor, 2 x CR123 batteries
Inputs	• 2x input for digital temperature sensors • 2x (NO or NC) input for magnet contact, failure signals, etc. • 1x 12 VDC
Output	• 1 output (open collector 200 mA). Activated after alarm or incoming SMS (pulse time or continuous)
Dimensions	• 80 x 60 x 40 mm
Configuration and reports	• Minimum and/or maximum temperature (-35 °C ... + 70 °C) • Display and configuration of temperature in °Celsius or Fahrenheit • Temperature value log interval (0 ... 999 minutes) • Temperature log values transfer interval to Internet Portal (0 ... 999 hours) • Alarm delay times, time-based arming/disarming, input NO/NC, frequency of test messages, siren on/off, alarm texts, temperature calibration, etc.
Temperature sensor	• Measurement range: -35 ... +70 °C • Accuracy: 0,5°C between -30 °C and +55 °C, 1° C outside these values • Digital sensor, no calibration needed • 1 meter cable
Ambient temperature	• -10°C ... +55°C
Power supply	• 2x CR123 lithium batteries (included) or • 12 VDC (or power adapter) + 2x CR123 lithium batteries
Battery life time (2 x CR123)	• > 1 year at 1 GSM message per day (battery operated) and daily synchronisation to portal • > 3 years at normal use (external power supply)
GSM/GPRS	• Quad band EGSM 900/1800 - 850/1900 MHz
Accessories (not included)	• Mains power adapter (12 VDC, 500 mA) • Second temperature sensor (1 meter or 10 meter cable) • Extension cable for temperature sensor (flat or round) • Magnet contact • Battery pack, battery life of 4 years

MOBEYE THERMOGUARD TWINLOG

CML2275 CML2285



Log, Alarm and Report temperature values

MOBEYE CML2275/CML2285



Continuous measurement of ambient temperature.
Two temperature sensor inputs.



Alarm upon violation of user-defined (minimum/maximum) temperature limits.



Logging of temperature values, synced in cloud-based portal. User-defined log and sync intervals.



Battery operated; battery life time >1 year at daily reporting. Longer lifetime possible.



If powered externally, monitoring of the power source and alarming at power failure is possible.



Manual or time-based arming and disarming.



NO/NC inputs for additional alarm options, such as a 'door open' notification.



Internal piezo siren for alarm indication. Additional output for activating an external device.

The Mobeye ThermoGuard TwinLog CML2275 and CML2285 are industrial units for remote monitoring, alarming and logging of temperature values.

The digital temperature sensors continuously measure the ambient temperature and compare the value(s) with the configured alarm limits. When the minimum and/or maximum temperature limits are violated, the ThermoGuard TwinLog will send alarm notifications and a siren sounds. Optionally, the unit can log the measured temperatures and send it to the Mobeye Internet Portal where the data is shown in graphs and tables.

The ThermoGuard TwinLog unit has an integrated GSM module and is designed to run on batteries. When powered by an externally source, it also serves as a power failure alarm.

Mobeye Internet Portal

With a regular SIM card the ThermoGuard Twinlog can send out alerts. However, by activating the Mobeye SIM card online additional functions become available:

- Logging of temperature values (user-defined intervals)
- Programming via portal
- Forwarding of messages to 'alarm contacts' and 'technical contacts' (call/SMS/e-mail)
- Monitoring of 'keep alive' (test) messages

Display

The Mobeye CML2275 and CML2285 are carried out in a solid IP66 housing.
The CML2285 is equipped with a display to read the actual temperature value(s).

Features

Alarm and alarm restore reports via call, SMS and e-mail*

- Temperature alarm
- Activated NO/NC input
- External power failure

Logging of temperature values*

- User-defined log interval
- User-defined data transfer interval (sync)
- Historical values, status, download options

Notifications

- Low internal battery voltage
- 'Keep alive' message at user defined interval
- Exception message if 'keep-alive' was not received timely*

Reports and status overviews

- Actual temperature
- GSM signal strength
- Position data at last event (cell-id)*

Options

- Min. and/or max. measurement range: -35 ... +70 °C
- 5 phone numbers
- Alarm texts
- Alarm delay times
- Temperature calibration
- Siren on/off

Arm and disarm

- Time-based arming and disarming with two schedules

When battery operated

- Fully autonomous operation when battery powered
- Battery life > 1 year (even in case of a daily report)

* features in combination with the Mobeye Internet Portal

Mobeye CML2275/CML2285 Technical Data

Content	• Main unit with integrated GSM module, 1 external temperature sensor 2x CR123 batteries
Inputs	<ul style="list-style-type: none"> • 2x input for digital temperature sensors • 2x (NO or NC) inputs for magnet contact, failure signals, etc. • 1x 12 VDC
Output	• 1 output (open collector 200 mA). Activated after alarm or incoming SMS (pulse time or continuous)
Dimensions	<ul style="list-style-type: none"> • CML2275: LED indication, on/off button • CML2285: LED indication, on/off button, display to read the actual temperature value(s) and alarm status • 162 x 82 x 55 mm, IP66 • temperature sensor cable: 1 meter
Temperature sensor	<ul style="list-style-type: none"> • measurement range: -35 ... +70 °C • accuracy: 0,5°C between -30 °C and +55 °C, 1°C outside these values • digital sensor, no calibration needed
Ambient temperature	• -10°C ... +55°C
Power supply	<ul style="list-style-type: none"> • 2x CR123 lithium batteries (included) or • 12 VDC (or power adapter) + 2x CR123 lithium batteries
Battery lifetime (2 x CR123)	<ul style="list-style-type: none"> • > 1 year at 1 GSM message per day (battery operated) and daily synchronisation to portal • > 3 years at normal use (external power supply)
GSM/GPRS	• Quad band EGSM 900/1800 - 850/1900 MHz
Accessories (not included)	<ul style="list-style-type: none"> • Mains power adapter (12 VDC, 500 mA) • Second temperature sensor (1 meter or 10 meter cable) • Extension cable for temperature sensor (flat or round) • Magnet contact • Battery pack, battery life of 4 years

Water detector with alarm notification always aware of leakage



CM4300

Mobeye WaterGuard

The Mobeye WaterGuard is the leak detector that helps to prevent water damage. The device consists of a reliable leakage sensor and a compact communication box. By placing the sensor close to a water source or at a place where water can accumulate, leakage can no longer occur unnoticed. If the sensor detects a water-based liquid, an alarm notification will be sent. The device is fully battery powered, or uses external power. The communication module can connect to the 4G LTE-M and the 2G network.

As soon as the water sensor or one of the additional inputs gets into the alarm status, a push notification, telephone call, SMS and/or e-mail will follow. The contact persons can be set, with multiple options for the alarm message. The Mobeye WaterGuard runs for more than a year on a set of batteries. When the battery voltage is low, a message is sent. When using an external power source (12-24V DC or mains), it also sends "power failure" notifications; this is often the first indication that something is wrong and an action is required.



Mobeye WaterGuard, reliable and simple

Next to the supplied leak sensor, two potential-free sensors can be connected, for example a water float sensor or failure contact. The settings are easy to program in, such as the alarm delay times, inactive times after an alarm, NO/NC input types, repeat notifications, test messages and alarm texts.

For monitoring a water level, the CM4300FS with float sensor is more suitable.

CM4300 Mobeye WaterGuard



HOW IT WORKS

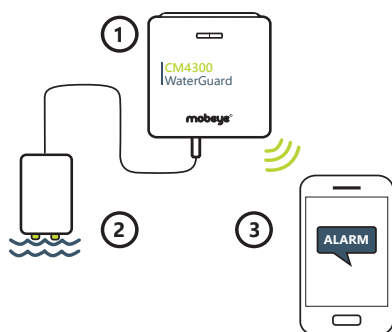

The Mobeye CM4300 monitors whether a room is dry. In the event of a water leak, it immediately sends a notification. This way you will detect a water leak in time and prevent water damage.

- 1 Place the box in a dry place and set the contacts for the notifications.
- 2 Fix the leak sensor where the water first will penetrate or accumulate, with the pins down.
- 3 As soon as the pins feel water, the WaterGuard sends alarm messages to the contact persons. When using the portal and app, an escalation plan including alarm confirmation can be set.

Mobeye SIM, Portal & App service

The Mobeye Internet Portal offers a clear dashboard and essential functions, such as push notifications per app, online programming, setting up the notifications, insight into the status and history, network strength, events and position (Cell-Id). The 'keep-alive' monitor offers extra security by monitoring the receipt of test messages. You can activate the supplied Mobeye SIM card online.

CM4300 - Technical data

Contents	<ul style="list-style-type: none"> CM4300, leakage sensor, 2x CR123 batteries, SIM card
(Alarm) messages	<ul style="list-style-type: none"> water alarm, input alarm, power failure, alarm recovery, battery low voltage, (missed) test report to private contacts via app, call, text message and/or e-mail
Reporting	<ul style="list-style-type: none"> status, setting list, event history, network strength and position based on Cell ID
Setting options	<ul style="list-style-type: none"> contacts (unlimited number) for alarm and service messages, message texts, repeat cycles, input type normally open or normally closed, recovery messages, alarm delay times, test interval (keep-alive), ARC, etc.
Operation	<ul style="list-style-type: none"> arming and disarming via button, time schedules and SMS
Water sensor	<ul style="list-style-type: none"> 52 x 32 x 14 mm, digital, 1 meter cable
Inputs	<ul style="list-style-type: none"> 1x input for leakage sensor, 2x NO/NC input (potential-free), 1x 12-24V DC (+/- 2V)
Power supply	<ul style="list-style-type: none"> 2x CR123 lithium batteries or 12-24V DC (regulated) + 2x CR123 lithium
Battery lifetime	<ul style="list-style-type: none"> > 1 year at normal use (battery operated), > 3 years at normal use (powered externally)
Dimensions	<ul style="list-style-type: none"> 94 x 94 x 28 mm
Connectivity	<ul style="list-style-type: none"> 4G LTE-M (worldwide) + 2G EGSM Quad band the Mobeye SIM card and Internet Portal provide full functionality and optimum security. The 4G LTE-M network is very reliable and ensures a strong penetration against low energy consumption. 2G is available as a fallback 2G EGSM Quad band (850/900/1800/1900 MHz) when using your own SIM card, the device works (only) on 2G. The operation is "stand-alone", without using the Mobeye Portal. The alarm notifications are sent via SMS and telephone call to (max.) 5 contacts. Programming is done via (simple) SMS commands
Accessories (not included)	<ul style="list-style-type: none"> mains adapter, extension cable (3m, 10m), external antenna

Mobeye is specialised in high-quality 2G/4G/LoRa alarm and telemetry technology. Visit mobeye.com for more information about our technology, applications and detailed product information.

security. anywhere. anytime.



Water detector with float sensor for level measurement with alarm transmission



CM4300FS

Mobeye WaterGuard

The Mobeye WaterGuard-FS informs contacts when the water level rises or falls. The device consists of a water float sensor and a compact communication box. By fixing the sensor in a horizontal position at the critical water level, it will be closed (when the water rises) or opened (when the water level falls). This is followed by an alarm message. The device is fully battery powered, or uses external power. The built-in communication module can connect to the 4G LTE-M and the 2G network.

If the water sensor of one of the inputs indicates an alarm status, a push notification, telephone call, SMS and/or e-mail will follow. The contact persons can be set, with multiple options for the alarm message.

The Mobeye WaterGuard-FS runs for more than a year on a set of batteries. A message is sent when the battery voltage is low. When using an external power source (12-24V DC or mains), it also sends "power failure" notifications; this is often the first indication that something is wrong and an action is required.



Mobeye WaterGuard-FS, reliable and effective

Next to the included water level sensor a second potential-free sensor may be connected, for example a second float sensor or failure contact. The settings are easy to program in, such as an alarm delay, inactive times after an alarm, repeat notifications, test messages and alarm texts. For detecting water leaks the CM4300 with leakage sensor is more suitable.

CM4300FS Mobeye WaterGuard



HOW IT WORKS

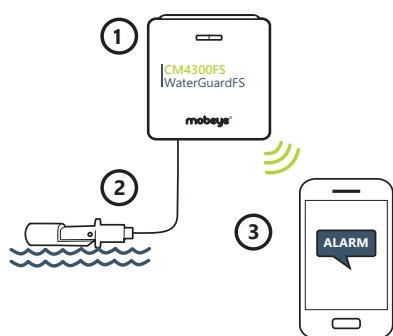

The Mobeye CM4300FS monitors whether the water level is at or below a pre-determined level. If the water level is too high or too low, it sends a message. This way you are informed well to take prompt action.

- 1 Place the box in a dry place and set the contacts for the notifications.
- 2 Decide at what water height you want to receive an alarm. Install the water float horizontally, if necessary with the aid of an attachment.
- 3 As soon as the water closes (or opens) the float sensor, the WaterGuard-FS sends alarm messages to the contact persons. When using the portal and app, an escalation plan including alarm confirmation can be set.

Mobeye SIM, Portal & App service

The Mobeye Internet Portal offers a clear dashboard and essential functions, such as push notifications per app, online programming, setting up the notifications, insight into the status and history, network strength, events and position (Cell-Id). The 'keep-alive' monitor offers extra security by monitoring the receipt of test messages. You can activate the supplied Mobeye SIM card online.

CM4300FS - Technical data

Contents	<ul style="list-style-type: none"> CM4300FS, water float sensor, 2x CR123 batteries, SIM card
(Alarm) messages	<ul style="list-style-type: none"> water alarm, input alarm, power failure, alarm recovery, battery low voltage, (missed) test report to private contacts via app, call, text message and/or e-mail, or to a control room (ARC)
Reporting	<ul style="list-style-type: none"> status, setting list, event history, network strength and position based on Cell ID
Setting options	<ul style="list-style-type: none"> contacts (unlimited number) for alarm and service messages, message texts, repeat cycles, input type normally open or normally closed, recovery messages, alarm delay times, test interval (keep-alive), ARC, etc.
Operation	<ul style="list-style-type: none"> arming and disarming via button, time schedules and SMS
Water sensor	<ul style="list-style-type: none"> suitable for water-based liquids, 1.5 meter cable (extendable with 2-core wire)
Inputs	<ul style="list-style-type: none"> 1x input for water float sensor, 1x NO/NC input (potential-free), 1x 12-24V DC (+/- 2V)
Power supply	<ul style="list-style-type: none"> 2x CR123 lithium batteries or 12-24V DC (regulated) + 2x CR123 lithium
Battery lifetime	<ul style="list-style-type: none"> > 1 year at normal use (battery operated), > 3 years at normal use (powered externally)
Dimensions	<ul style="list-style-type: none"> 94 x 94 x 28 mm
Connectivity	<ul style="list-style-type: none"> 4G LTE-M (worldwide) + 2G EGSM Quad band the Mobeye SIM card and Internet Portal provide full functionality and optimum security. The 4G LTE-M network is very reliable and ensures a strong penetration against low energy consumption. 2G is available as a fallback 2G EGSM Quad band (850/900/1800/1900 MHz) when using your own SIM card, the device works (only) on 2G. The operation is "stand-alone", without using the Mobeye Portal. The alarm notifications are sent via SMS and telephone call to (max.) 5 contacts. Programming is done via (simple) SMS commands
Accessories (not included)	<ul style="list-style-type: none"> mains adapter, external antenna, float sensor for other substances (e.g. diesel)

Mobeye is specialised in high-quality 2G/4G/LoRa alarm and telemetry technology. Visit mobeye.com for more information about our technology, applications and detailed product information.

security. anywhere. anytime.

Mobeye fire detectors with alarm reporting to contacts



CM4400

Mobeye 2G/4G Smoke Detector

The Mobeye 2G/4G fire detector series consists of reliable smoke and heat detectors with alarm notification to contact persons. The combination of Ei Electronics fire detectors and the Mobeye communication module makes fire alarms extremely effective. In the event of a fire detection, in addition to the siren on the spot, a warning will be sent via push message, telephone call, SMS and/or e-mail. No cables and local telephone line are required. The set is fully battery powered. This makes installation easy. The built-in communication module can connect to the 4G LTE-M and 2G network.

The Ei Electronics smoke detector has a 10-year battery. Mobeye communication module works for more than a year on batteries. A message is sent when the batteries need to be replaced.



Stand-alone fire detectors, or several detectors in a network

The CM4400 is suitable for situations where one smoke detector is sufficient. With several interconnected fire detectors, only one CM4400RF needs to be included in the network. The CM4400RF contains an RF module to connect wirelessly to other Ei Electronics detectors. As soon as one of the detectors notices a fire, all sirens will sound and the communication module will send a notification.



If smoke detectors are unsuitable, heat detectors are an alternative.

CM4400

Mobeye 2G/4G Smoke Detector



HOW IT WORKS



The Mobeye CM4400 smoke detector warns people on the spot in the event of a fire, as well as contacts elsewhere. It makes the difference in helping the vulnerable and in the event of fire in vacant buildings.

- 1 Activate the detector in a few steps and set up the contacts.
- 2 Mount the smoke detector to the ceiling in a clean and dry area.
- 3 In the event of a fire, the siren sounds and the set contacts are informed by telephone.

Mobeye SIM, Portal & App service

The Mobeye Internet Portal offers a clear dashboard and essential functions, such as push notifications per app, online programming, setting up the notifications, insight into the status and history, network strength, events and position (Cell-Id). The 'keep-alive' monitor offers extra security by monitoring the receipt of test messages. You can activate the supplied Mobeye SIM card online.

CM4400 - Technical data

Article number CM4400	Product
CM4400RF	<ul style="list-style-type: none"> 4G communication module with Ei Electronics smoke detector, for stand-alone use 1x CM4410, 1x Ei605TYC, 2x CR123 batteries, SIM card
CM4400H	<ul style="list-style-type: none"> 4G communication module with Ei Electronics smoke detector and RF module, for use in network with Ei detectors 1x CM4410, 1x Ei605TYC, 1x Ei650M, 2x CR123 batteries, SIM card
CM4400HRF	<ul style="list-style-type: none"> 4G communication module met Ei Electronics heat detector, for stand-alone use 1x CM4410, 1x Ei603TYC, 2x CR123 batteries, SIM card
CM4410	<ul style="list-style-type: none"> 4G communication module with Ei Electronics heat detectoren and RF module, for use in network with Ei detectors 1x CM4410, 1x Ei603TYC, 1x Ei650M, 2x CR123 batteries, SIM card 4G communication module as extension set for Ei605TYC or Ei603TYC 1x CM4410, 2x CR123 batteries, SIM card
(Alarm) messages	<ul style="list-style-type: none"> fire alarm, battery low voltage, (missed) test report to private contacts via app, call, text message and/or e-mail, or to a control room (ARC)
Setting options	<ul style="list-style-type: none"> contacts (unlimited number) for alarm and service messages, message texts, test interval (keep-alive), ARC, etc.
Power supply CM4410	<ul style="list-style-type: none"> 2x CR123 lithium batteries (battery life time: > 1 year at normal use)
Dimensions	<ul style="list-style-type: none"> diameter 12 cm, height 6,7 cm
Smoke detector	<ul style="list-style-type: none"> optical smoke detector (>85 dB at 3 m), complies EN 14604, for use in residential areas, 0 °C ... 40 °C
Connectivity	<ul style="list-style-type: none"> 4G LTE-M (worldwide) + 2G EGSM Quad band the Mobeye SIM card and Internet Portal provide full functionality and optimum security. The 4G LTE-M network is very reliable and ensures a strong penetration against low energy consumption. 2G is available as a fallback 2G EGSM Quad band (850/900/1800/1900 MHz) when using your own SIM card, the device works (only) on 2G. The operation is "stand-alone", without using the Mobeye Portal. The alarm notifications are sent via SMS and telephone call to (max.) 5 contacts. Programming is done via (simple) SMS commands
Accessories (not included)	<ul style="list-style-type: none"> additional Ei Electronics interconnectable smoke, heat and CO detectors

Mobeye is specialised in high-quality 2G/4G/LoRa alarm and telemetry technology. Visit mobeye.com for more information about our technology, applications and detailed product information.

security. anywhere. anytime.

MOBEYE CM-GUARD TWINLOG

CML2055



Log, Alarm and Report analogue values

Mobeye CML2055



Alarm upon violation of user-defined (minimum/ maximum) analogue value limits.



Logging of analogue values, synced with cloud-based portal. User-defined log and sync intervals.



Battery operated; battery lifetime >1 year with daily report. Longer lifetime possible.



If powered externally, monitoring power source and alarming at power failure.



Manual or time-based arming and disarming.



Two NO/NC inputs for additional alarm options.



Output to control an external device.

The Mobeye CM-Guard Twinlog is a compact unit for remote monitoring of analogue values.

The CM-Guard TwinLog will instantly send alarm notifications when user-defined analogue values are violated. Measured values can be logged and viewed in the (optional) web-based portal.

The CML2055 has an integrated GSM module and is designed to run on batteries. The CML2055 also serves as a power failure alarm if the unit is externally powered.

Mobeye Internet Portal

The CML2055 only needs a SIM card of any provider to operate. Equipped with a Mobeye SIM card and registered on the Mobeye Internet Portal, more features become available:

- Logging of analogue values (user-defined intervals)
- Programming via internet portal
- Forwarding of messages to 'alarm contacts' and 'technical contacts' (call/SMS/e-mail)
- Monitoring of 'keep alive' (test) messages



Alarm and restore reports via call, SMS and e-mail*

- alarm on analogue values
- activated NO/NC input
- external power failure

Logging of analogue values*

- user-defined log interval
- user-defined data transfer interval (sync)
- historical values, status, download options

Notifications

- low internal battery voltage
- 'keep alive' messages at user defined interval
- exception message ('no keep alive')*

Reports and status

- GSM signal strength
- status and settings
- position data at last event (cell-id)*

Options

- unit of measurement (e.g. volt)
- 5 phone numbers
- alarm texts
- alarm delay times

Arm and disarm

- time-based arming and disarming with two schedules

When battery operated

- fully autonomous operation when battery powered
- battery life > 1 year (with daily report)

* features in combination with the Mobeye Internet Portal

Mobeye CML2055 Technical data

Inputs	<ul style="list-style-type: none"> • 2x input (NO/NC/Analogue) • 1x 12 VDC
Output	<ul style="list-style-type: none"> • 1 output (open collector 200 mA) activated after alarm or incoming SMS (pulse time or continuous)
Security	<ul style="list-style-type: none"> • PIN code
Values	<ul style="list-style-type: none"> • Alarm limits for analogue values: 0 ... 48V (accuracy 0,1V, peaks up to 70V)
Dimensions	<ul style="list-style-type: none"> • 80 x 60 x 40 mm
Power supply	<ul style="list-style-type: none"> • 2x CR123 lithium batteries (included) or • 12 VDC (or power adapter) + 2x CR123 lithium batteries
Battery life time (2 x CR123)	<ul style="list-style-type: none"> • > 1 year at 1 GSM message per day (battery operated) and daily synchronisation to portal • > 3 years at normal use (external power supply)
GSM/GPRS	<ul style="list-style-type: none"> • Quad band EGSM 900/1800 - 850/1900 MHz
Ambient temperature	<ul style="list-style-type: none"> • -10°C ... +55°C
Accessories (not included)	<ul style="list-style-type: none"> • Mains power adapter (12 VDC, 500mA) • Outdoor enclosure • External battery pack for extended battery lifetime

About Mobeye

The company Mobeye is specialized in high quality 2G/3G/4G/LoRa alarm and telemetry technology. Mobeye products are characterised by configuration flexibility, user friendliness and an extremely low power consumption. Mobeye aims to design and market products that contribute to a safer world for its customers.

MOBEYE SISTM-V2

Standard Industrial Sensor Transmitter Module

Sensor values

0 – 1 V

0 – 10 V

NO/NC



Log, Alarm and Report of industrial sensor values

Mobeye SISTM-V2 is meant for measuring the standard industrial sensors. By connecting sensors to the inputs and by setting limit values, alarm messages will be sent per call, mail and/or SMS text message. At a user-defined interval, the sensor values are logged.

The Mobeye SISTM-V2 CML2015 is a 2-channel module. The inputs are programmable for different types of sensors. The system can run completely autonomously being battery operated or be powered by a 6-24VDC source. The built-in communication module transmits alarm messages and log values via the mobile network.

Reading out sensors

The Mobeye SISTM is capable of reading almost any analog sensor. The sensor output can be a signal between 0 and 1V or 0 and 10V value. The inputs of the Mobeye SISTM are also suitable for potential-free contacts.

The power supply of the sensors

The default SISTM-V2 has an external source is connected for the power supply to the sensors and SISTM. A special battery-operated version is available which makes it possible that both the transmitter module and the sensors operate fully battery-powered.

Mobeye Internet Portal

Mobeye SISTM is able to log the values and to transmit them to the Mobeye Internet Portal via the built-in GSM module. A Mobeye a SIM card and registration in the Internet portal offers the full functionality:

- logging of values (user-defined intervals)
- programming via portal
- forwarding of messages to 'alarm contacts' and 'technical contacts' (call/SMS/e-mail)
- monitoring of 'keep alive' (test) messages

MOBEYE SISTM



GSM notification of exceeding sensor values.



Logging of values, sync with web portal.



Fully battery-operated or externally powered.

Mobeye SISTM Technical details

Features	<ul style="list-style-type: none">• logging of values• (instant) alarm and alarm restore on the actual values by SMS, call and e-mail• power failure and power restore by SMS, call and e-mail• test messages ('keep alive') and "keep alive monitor"
Configuration	<ul style="list-style-type: none">• alarm telephone numbers (call, SMS text message); e-mail address• each sensor input: sensor type, alarm limits, alarm delay times, texts, measuring factor, unit of measure (e.g. Volt), calibration, warming up time of sensor, sample frequency• sync interval• schedules for time controlled switching on and off• frequency of test messages
Power consumption	<ul style="list-style-type: none">• In 'low power' mode: ca. 50 μA (excl. sensors)• In 'high power' mode: ca. 50 mA (excl. sensors)• sensors can be powered externally, or by the Mobeye SISTM in the low power sample mode
Power supply to sensors	<ul style="list-style-type: none">• own power supply or powered by Mobeye SISTM (5 or 15VDC)
Power supply to unit	<ul style="list-style-type: none">• via external lithium battery pack AC-BP5 (Mobeye accessory) (up to 5 years at 4 measurements/hour and daily sync to web portal)• via 6 ~ 24VDC input, optionally with 2x backup Varta CR123 Lithium for power failure message
Communication	<ul style="list-style-type: none">• Quad band EGSM 900/1800 - 850/1900 MHz

About Mobeye

The company Mobeye is specialized in high quality GSM/3G/4G-based alarm and telemetry technology. Mobeye products are characterised by configuration flexibility, user friendliness and an extremely low power consumption. Mobeye aims to design and market products that contribute to a safer world for its customers.

MOBEYE CombiGuard

Mobeye CM2600



The complete monitoring system. Keeps an eye on power, temperature, water and voltage

The Mobeye CombiGuard combines various sensors and signals for optimum control and monitoring. Should the CM2600 detect a problem with regards to temperature, water level, battery voltage, potential-free sensors and/or the power supply, it will send out an alert via SMS text message, call and / or e-mail.

Monitoring risk factors will help preventing damage to your property. The Mobeye CombiGuard keeps you informed of the situation and allows you to remotely switch a device. If desired, the bilge pump, air conditioner or heater can start automatically after an alarm or remotely via an SMS command. No power source nearby? The Mobeye CombiGuard can operate on batteries for a long time.



Mobeye Internet Portal offers additional features. By activating the included Mobeye SIM card and the CombiGuard online you increase user-friendliness and you get extra functions. The portal facilitates online programming, shows the status -such as the battery voltage and the alarm history- and monitors the test messages. You will only receive exception messages.

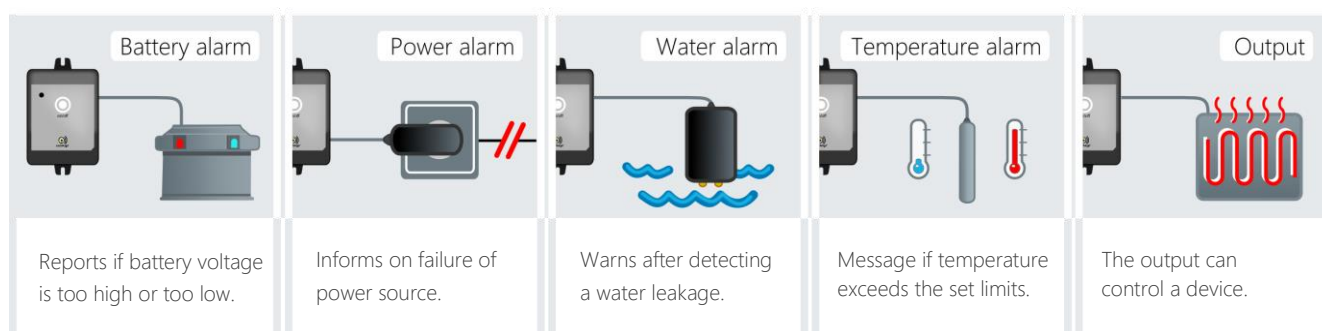

Mobeye CombiGuard CM2600 Technical data



Content	<ul style="list-style-type: none"> • CM2600 / CombiGuard main unit with integrated GSM module • Temperature sensor 1 meter cable (extendable up to 20 meters), accuracy: 0.5 ° C between -30 ° C and +55 ° C, 1 ° C outside these limits • Water leakage sensor 1,5 meter cable (extendable up to 2,5 meters) • 12 VDC mains power adapter • 2x CR123 lithium batteries • Mobeye SIM card for connection to Mobeye Internet Portal (multi-provider SIM card, can be used internationally)
Inputs	<ul style="list-style-type: none"> • Analogue input for battery (0-48 V with peaks up to 60 V). Min. and max. limit adjustable • NO / NC / analogue input for additional sensor, second battery or failure signal
Output	<ul style="list-style-type: none"> • 1 output (open collector, max. 200 mA). Works when using external voltage • Switches after an alarm, SMS command or call, during pulse time or continuously
Dimensions	<ul style="list-style-type: none"> • 80 x 60 x 40 mm
(Alarm) messages	<ul style="list-style-type: none"> • Alarm messages via call, SMS, and/or e-mail*: <i>confirmation by receiver of alarm is possible, so the next contact person does not receive a call</i> <ul style="list-style-type: none"> • when the temperature exceeds the set limits • after the leak sensor detects water • when the battery voltage exceeds set limits, with the mention of the measured voltage • when an input is activated • When external (shore) power fails and with power recovery • Warning messages via SMS and/or e-mail*: <ul style="list-style-type: none"> • when the internal battery voltage is low • in the situation of a missed test report ("keep alive") (without using the portal: test notifications via SMS)
Reports	<ul style="list-style-type: none"> • Status reports, settings report, GSM network strength, position data at last event (cell-id)*
Security	<ul style="list-style-type: none"> • PIN code security for configuration
Configuration	<p>Programming is done online in the Mobeye Internet Portal (or without Portal: via text messages):</p> <ul style="list-style-type: none"> • telephone numbers (max. 5, unlimited number of SMS/emails when using the Mobeye Internet Portal) • min. and/or max. measurement range between -35 ... +70 °C • min. and/or max. battery voltage limits between 0 ... 48 V • identification and alarm texts, alarm delay times, alarm repeat times, locking of on/off button • input on analogue, NO or NC • output control mode and pulse time • frequency of test messages
Power supply	<ul style="list-style-type: none"> • 2x CR123 lithium batteries (included) or • 12 VDC (or power adapter) + 2x CR123 lithium batteries
Battery lifetime	<ul style="list-style-type: none"> • > 1 year at normal use (battery operated) • > 3 years at normal use (ext. power supply)
GSM/GPRS	<ul style="list-style-type: none"> • Quad band EGSM 900/1800 - 850/1900 MHz

* e-mail function only possible when using the Mobeye Internet Portal

About Mobeye

The company Mobeye is specialized in high quality 2G/3G/4G/LoRa alarm and telemetry technology. Mobeye products are characterised by configuration flexibility, user friendliness and an extremely low power consumption. Mobeye aims to design and market products that contribute to a safer world for its customers.

Mobeye Call-Key, GSM door opener. Security. Anywhere, anytime.



MOBEYE MCK100



Call to open

Call the lock to get access. Authorisation up to 500 telephone numbers.



Authorisation

For each number you assign unlimited access or specific time windows.



Timer

Automatic daily opening hours. Each day can have its own opening and closing time.



History

The portal displays who opened the lock and who was refused.

Stand alone

The Mobeye Call-Key can also be used 'stand alone', without the Mobeye Internet Portal and with a SIM card from any telecom provider (preferably M2M). Programming of authorisations and settings is done via SMS commands. Authorisation for unlimited (24/7) access is possible up to 50 phone numbers.

MOBEYE CALL-KEY

Your phone is the key!

The Mobeye Call-Key is a user-friendly and secure access control system for buildings with one door, fences or gates and for situations with changing access rights. Authorised people can open the door by simply calling the door lock.

Easy authorisation

Granting access is easy. In the secured online portal you assign the access rights, unlimited or only for specific windows (period, day, time). Only if the phone number was authorised, the Mobeye Call-Key grants access. In addition, automatic opening hours are possible.

Using its internal GSM communication module, the Mobeye Call-Key exchanges settings and logs with the portal. The authorised numbers are stored locally. An Internet connection near the lock is not required!

Electronic locks and strike plates

The Mobeye Call-Key can be connected to all electronic locks and strikes that work via a pulse or switch command.

Mobeye Call-Key MCK100

Configuration	<ul style="list-style-type: none"> Via the internet portal without Internet Portal: via SMS commands
Outputs	<ul style="list-style-type: none"> 2x relays output for electronic door opener (max. 2A/30VDC)
Authorisations	<div> <ul style="list-style-type: none"> Maximum of 500 authorised telephone numbers. User groups allow access privileges, possibly limited to a period and day schedules. The Mobeye Call-Key verifies whether incoming calls are from a - currently - authorised number. Only if this is allowed the relay contact switches. The second output is switched via a text message. without Internet Portal: max. of 50 authorised telephone numbers. Only unlimited (24/7) access. </div> <div> <p>Contact management</p> <p>Group name: <input type="text" value="Visitors X-mass 2017"/></p> <p>Limited access: <input checked="" type="checkbox"/></p> <p>Access period: <input checked="" type="checkbox"/> of <input type="text" value="23-12-2017"/> to <input type="text" value="31-12-2017"/></p> <p>Monday: <input type="text" value="00:00"/> - <input type="text" value="24:00"/> and <input type="text" value="00:00"/> - <input type="text" value="00:00"/></p> <p>Tuesday: <input type="text" value="00:00"/> - <input type="text" value="24:00"/> and <input type="text" value="00:00"/> - <input type="text" value="00:00"/></p> <p>Wednesday: <input type="text" value="00:00"/> - <input type="text" value="24:00"/> and <input type="text" value="00:00"/> - <input type="text" value="00:00"/></p> <p>Thursday: <input type="text" value="00:00"/> - <input type="text" value="24:00"/> and <input type="text" value="00:00"/> - <input type="text" value="00:00"/></p> </div>
Options	<ul style="list-style-type: none"> Pulse times for the outputs (or hard switching), option for unauthorised switching, delay times for alarm inputs and power failure, input type (NO/NC), free alarm texts, alarm suppression for intruder function, interval of the 'keep-alive' messages, security code.
Keep-alive monitor	<ul style="list-style-type: none"> The 'keep-alive'-monitor checks the communication with the GSM door opener. If the communication with the unit has been disconnected, the (service) contacts will receive a warning. without Internet Portal: possibility to receive test messages with a self-defined interval.
Data storage and synchronisation	<ul style="list-style-type: none"> The Mobeye Call-Key uses the local settings to verify that incoming calls may result in opening the lock. The Mobeye Internet Portal serves as a programming tool. The Mobeye Call-Key automatically synchronises new settings and logged events every hour. This happens 'over the air' with the internal GSM communication module. Therefore, no internet connection is required near the lock. without Internet Portal: programming via SMS commands
Technical data	<ul style="list-style-type: none"> Power: 9-32VDC / 500 mA (12V mains adapter included) optional: 4x CR123 batteries for power failure alarm messages Dimensions: 145 x 90 x 45 mm Communication module: Quad band EGSM 900/1800 - 850/1900 MHz Ambient temperature: -10° C ... 55° C



Mobeye SIM card

With the Mobeye SIM card you register the Call-Key on the Mobeye Internet Portal. The flat fee costs are about equivalent to a standard SIM card subscription.

About Mobeye

Mobeye is Dutch manufacturer of GSM alarm and security products, with its own R&D team. The Mobeye range includes products for burglary, temperature monitoring, water detection, fire detection, etc. The Internet of Things portal offers additional functionality for the user. Mobeye aims to design and market products that contribute to a safer world for its customers.

MOBEYE LOW POWER PIR

Mobeye MPIR-LP

Kabelgebundener batteriebetriebener Bewegungssensor

Der Mobeye Bewegungsmelder vervollständigt Ihr Mobeye Alarmsystem. Dieser batteriebetriebene Passiv-Infrarot-Sensor (PIR) kann mit einem Alarmsystem, wie dem Mobeye Argos, verkabelt werden. Das Alarmsystem sendet eine Alarmmeldung, sobald der Bewegungssensor Aktivität erkennt.

Der MPIR hat einen extrem geringen Stromverbrauch und läuft mehrere Jahre mit der internen Batterie. Sie schließen das MPIR an einen der ("normally open") Eingänge des Mobeye Alarmsystems an. Das Mobeye Argos Einbruchsystem verfügt über eine Ein- und Ausgangsverzögerung, was bedeutet, dass der PIR der Alarmanlage einen zusätzlichen Sensor verleiht. Das MPIR kann an der Wand oder Decke montiert werden.



Technische Daten

Erkennungsmethode	• Passiv-Infrarot
Erfassungsbereich	• 12 x 12 m, 85° Ecke
Empfindlichkeit	• Haustierimmun
Montagehöhe	• 1,5 – 2,4 m
Anschluss	• 2-adriges Kabel (1,5m mit inbegriffen)
Abmessungen	• 97 x 65 x 78 mm
Verwendung	• Innen
Stromversorgung	• 1x CR123 (mit inbegriffen)
Batteriedauer	• 5 Jahre je nach Nutzung
Technologie	• Kombination von Optex und Mobeye Technologie