

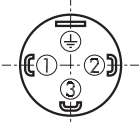
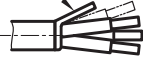
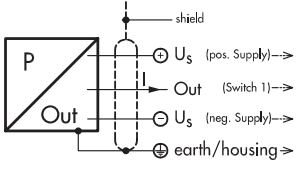

Technical specification

- Supply Voltage: 24 (9...32)VDC
- Switching current: ≤ 0.5 A @ -40...+85°C (Option: ≤ 0.4 A @ +85...+125°C)
- Mounting torque: 25 Nm
- Ambient temperature: -25°C ... +85°C (Option: -40°C ... +125°C)
- Media temperature: -40°C ... 125°C
- Switchpoint: Factory set or programmable on site with Trafag's Sensor Communicator SC (electrical connection 04 only)

Electrical connections

Protection	IP65 (IP67)	IP69K
Version	EN175301-803-A (DIN43650-A)	Cable*
Switch Output		Abschirmung écran / shield 
 8320.XX.XXXX.XX.T1	1 2 3 	brown blue black yellow/green

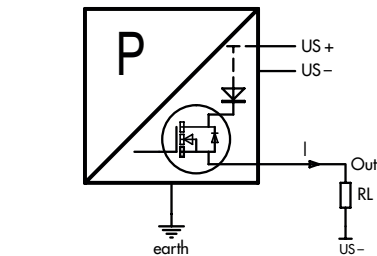

Connection of loads on switch contacts

* Ventilation via cable end

Programming device Sensor Communicator SC



Sensor Communicator SC
Programming cable with connector
EN175301-803-A

Manual see:
www.trafag.com/H73699 (english) H73698 (german)

Ordering No.

F88030
F88049

DIMENSIONS

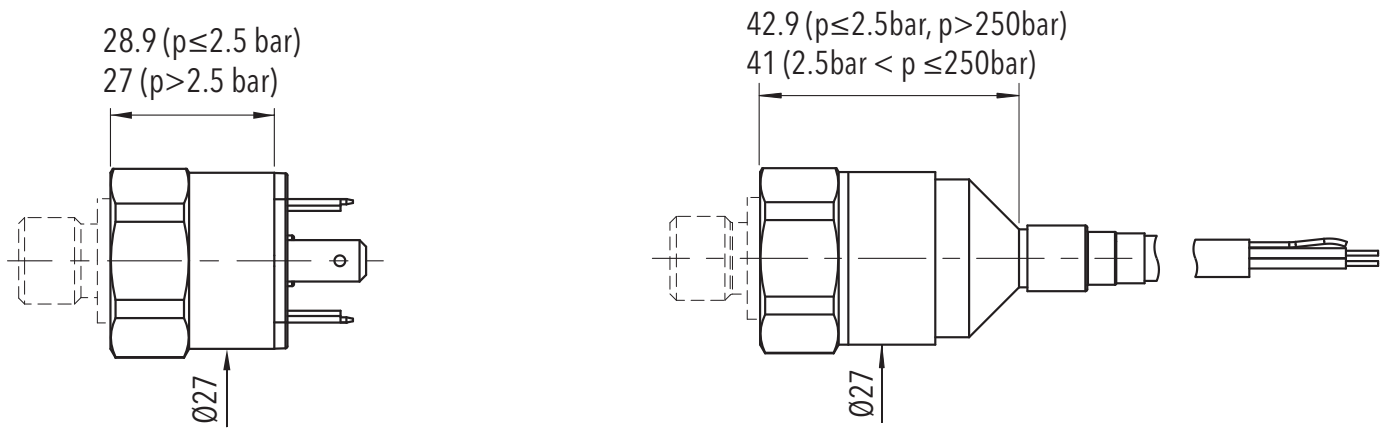

8320.XX.XXXX.04.XX.XX

Switchpoint factory set or programmable on site
with Trafag Sensor Communicator SC

8320.XX.XXXX.78.XX.XX

8320.XX.XXXX.88.XX.XX

Switchpoint factory set

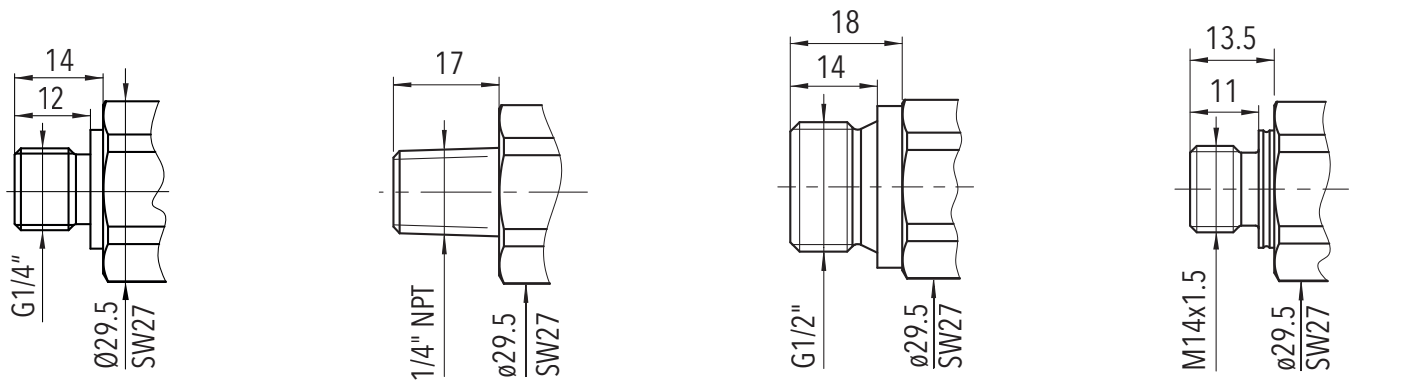

8320.XX.XX17.XX.XX

8320.XX.XX30.XX.XX

8320.XX.XX21.XX.XX

8320.XX.XX22.XX.XX

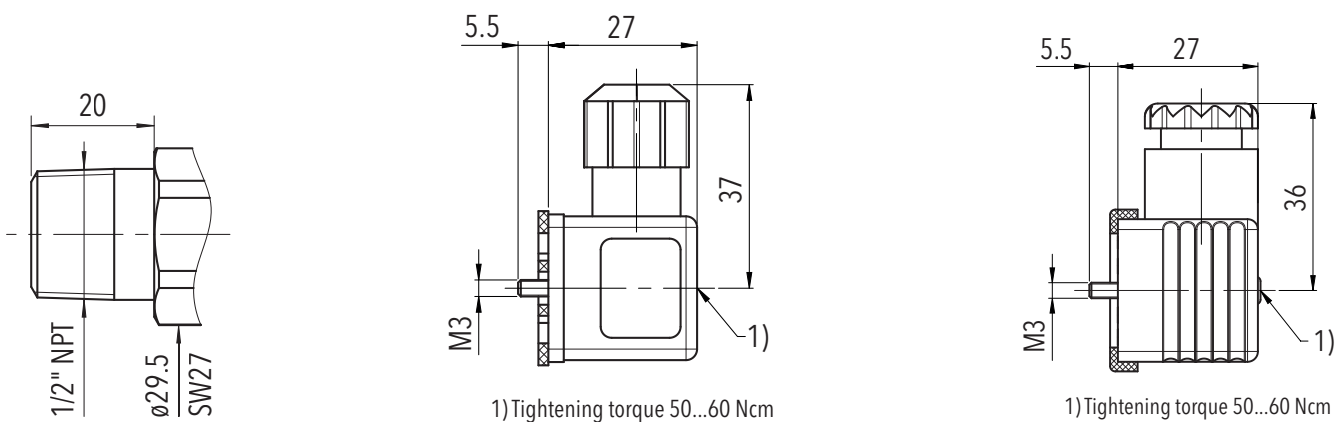

8320.XX.XX51.XX.XX

8320.XX.XXXX.XX.XX.46/56

8320.XX.XXXX.XX.XX.58