



Sensor Master by Trafag AG

**Technical specification**

Mounting torque: 15 ... 20 Nm  
 Ambient temperature: -25°C ... +85°C  
 Media temperature: -25°C ... +85°C  
 Protection: IP67  
 Display pressure unit: bar, psi, MPa, kPa, mWC, mmWC, inchWC, %, user scale  
 Switching current: Max. 0.5 A per switching output  
 Parametrisation: With 3 buttons and menu navigation or via NFC - Smartphone App

**Type label description**

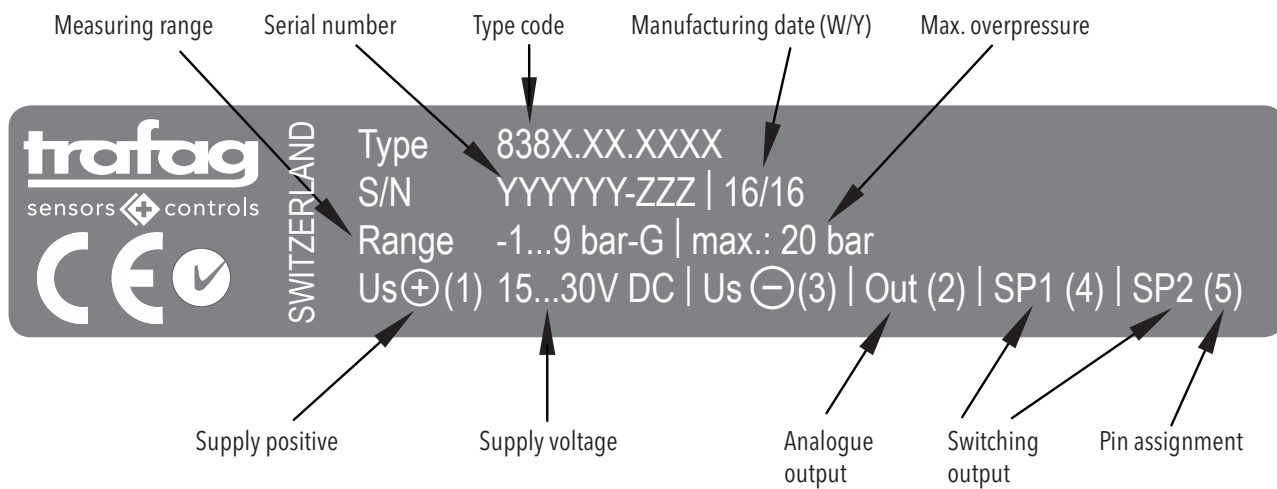

**Electrical connection**

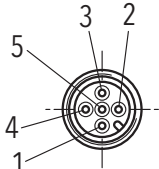
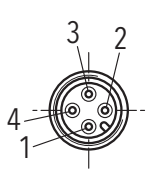
|                           |   |   |
|---------------------------|---|---|
| <b>Ingress Protection</b> | IP67*)  | IP67*)  |
| <b>Designation</b>        | M12x1<br>5-pole   | M12x1<br>4-pole   |
| <b>Type code</b>          | 838X.XX.XXXX <b>35</b>  | 838X.XX.XXXX <b>32</b>  |
| <b>Pin configuration</b>  |  |  |

\*) Provided female connector is mounted according to instructions

**Output signal / supply voltage**

| Output       | I <sub>SUPPLY</sub> | U <sub>SUPPLY</sub> |
|--------------|---------------------|---------------------|
| 4 ... 20 mA  | ≤ 30 mA             | 15 ... 30 VDC       |
| 0 ... 10 VDC | ≤ 30 mA             | 15 ... 30 VDC       |
| 0 ... 5 VDC  | ≤ 30 mA             | 15 ... 30 VDC       |
| 1 ... 6 VDC  | ≤ 30 mA             | 15 ... 30 VDC       |

## Connection of the measuring equipment

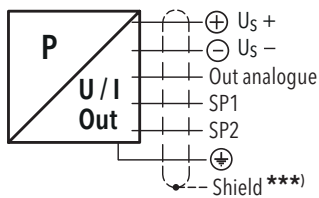

\*\*\*) The use of a shielded cable is recommended

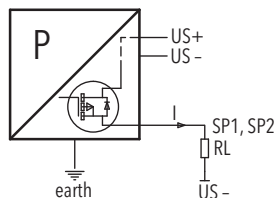

Connection of loads to switching output

4...20mA: min./max resistor vs. supply voltage @ Pmax = 100%

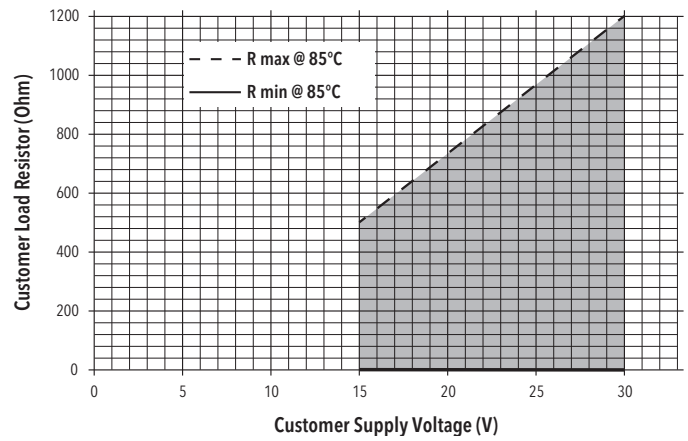

## Mounting

Tighten the device

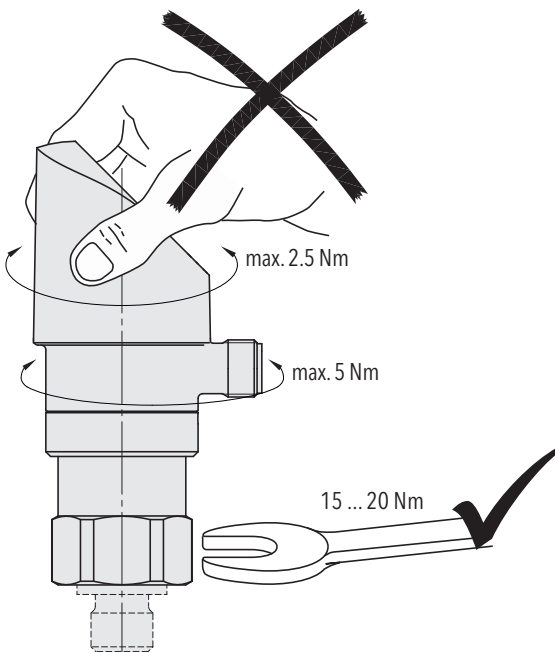

## Display indication

|       | Description   |
|-------|---|
| OL    | The measured pressure is >3% above the measuring range end-point<br>→ The indication disappears as soon as the pressure is reduced again  |
| UL    | The measured pressure is >3% below the measuring range zero-point<br>→ The indication disappears as soon as the pressure is reduced again   |
| Perr  | Signal processing is faulty.<br>→ Please replace measuring device   |
| FALS  | Incorrect access code<br>→ Enter the correct access code  |
| Sbrk  | Sensor break; the sensor element is defective<br>→ Please replace the pressure measuring device   |
| Fi2c  | Internal device communication is interrupted<br>→ Please replace the pressure measuring device  |
| Ecrc  | Internal memory damage occurred<br>→ Execute a factory reset. If the recovery is not successful, replace the pressure measuring device  |
| FE2P  | Internal memory damage occurred<br>→ Execute a factory reset. If the recovery is not successful, replace the pressure measuring device  |
| EnFc  | NFC communication was not successful<br>→ Try again to communicate again. If the error persists, replace the pressure measuring device  |
| E.OFC | Zero-set out of range<br>The measured pressure value is outside of the valid range for the zero-set function<br>→ Press [Enter] → on the measuring device to reset the error indication<br>This error indication does not appear when performing the zero-set function by means of the Sensor Master App (Android smartphone) |

## Switching output functions

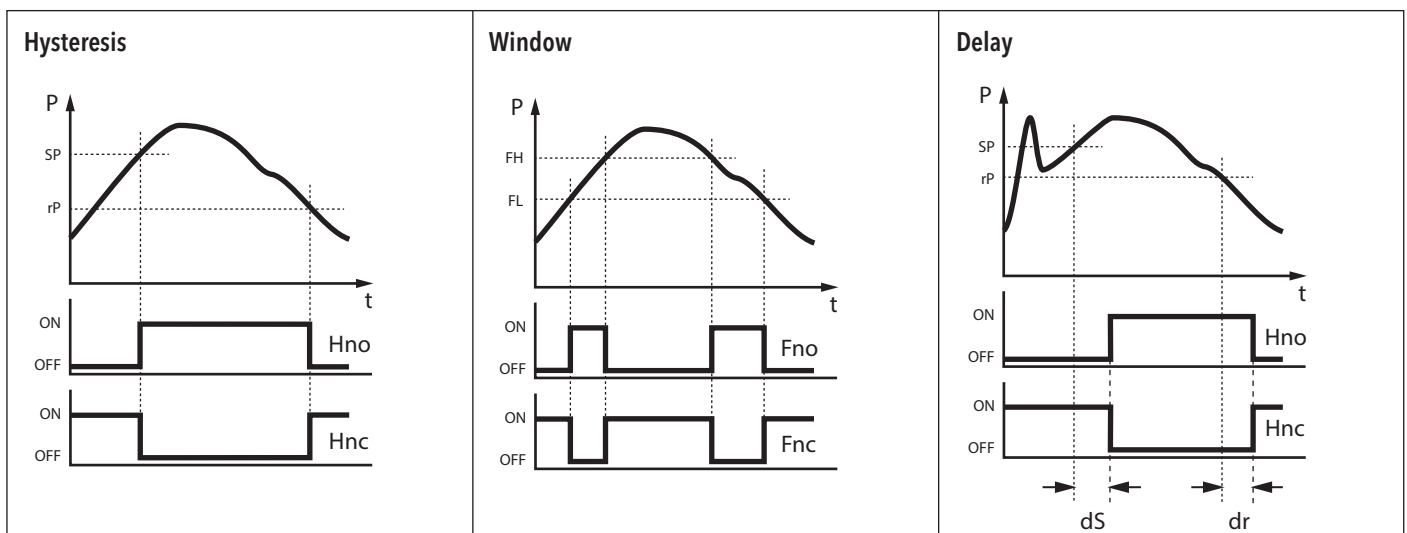

# Dimensions

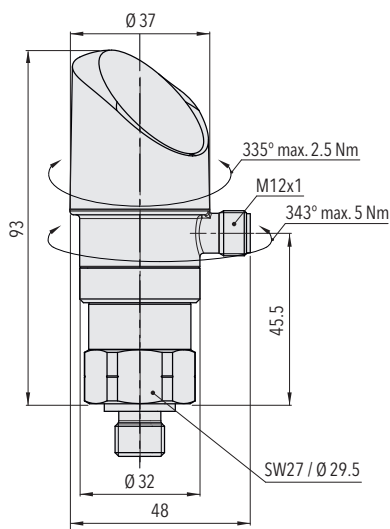

838X.XX.XXXX.35/32.XX.XX

Protective cap

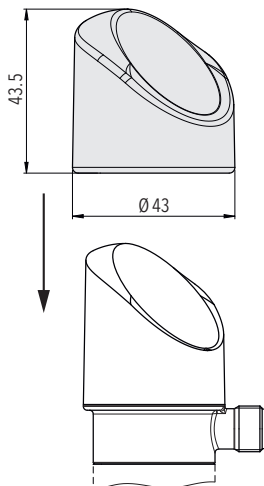

Flange adapter

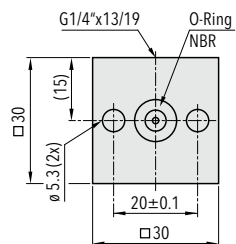

F82054  
Mounting accessory included

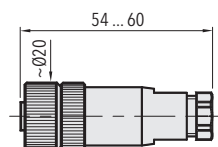

838X.XX.XXXX.XX.XX.33

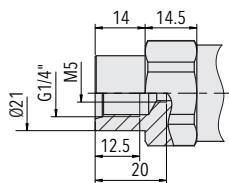

838X.XX.XX10.XX.XX.XX

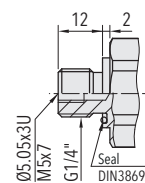

838X.XX.XX17.XX.XX.XX

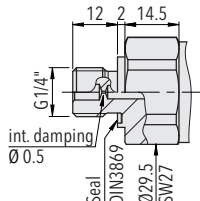

838X.XX.XX15.XX.XX.XX

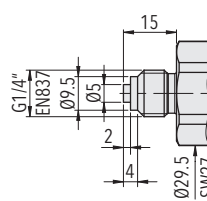

838X.XX.XX53.XX.XX.XX

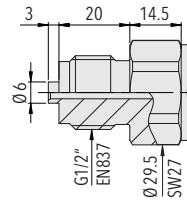

838X.XX.XX11.XX.XX.XX

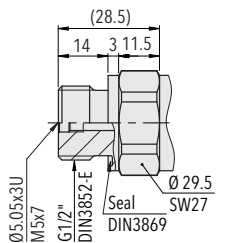

838X.XX.XX41.XX.XX.XX

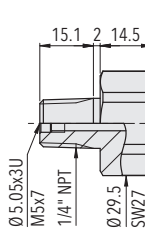

838X.XX.XX30.XX.XX.XX

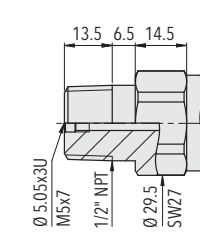

838X.XX.XX51.XX.XX.XX

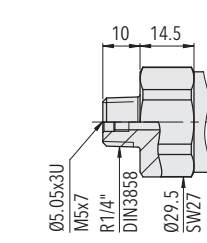

838X.XX.XX19.XX.XX.XX

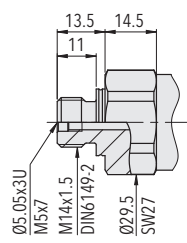

838X.XX.XX31.XX.XX.XX

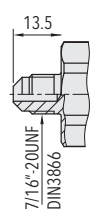

838X.XX.XX18.XX.XX.XX

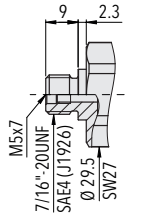

838X.XX.XX42.XX.XX.XX

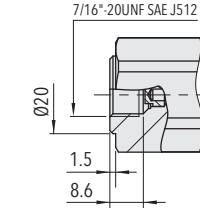

838X.XX.XX24.XX.XX.XX

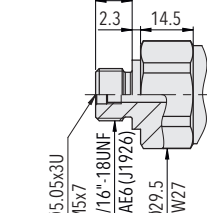

838X.XX.XX61.XX.XX.XX

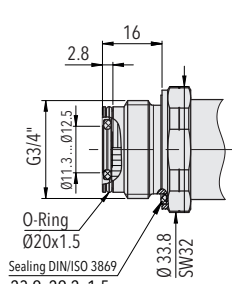
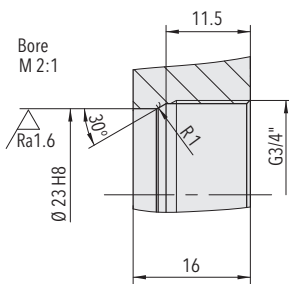

8380.XX.XX52.XX.XX.XX

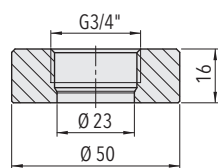

Welding flange for G3/4" frontal membrane (1.4301)  
Ordering No. C27805

# Operating menu

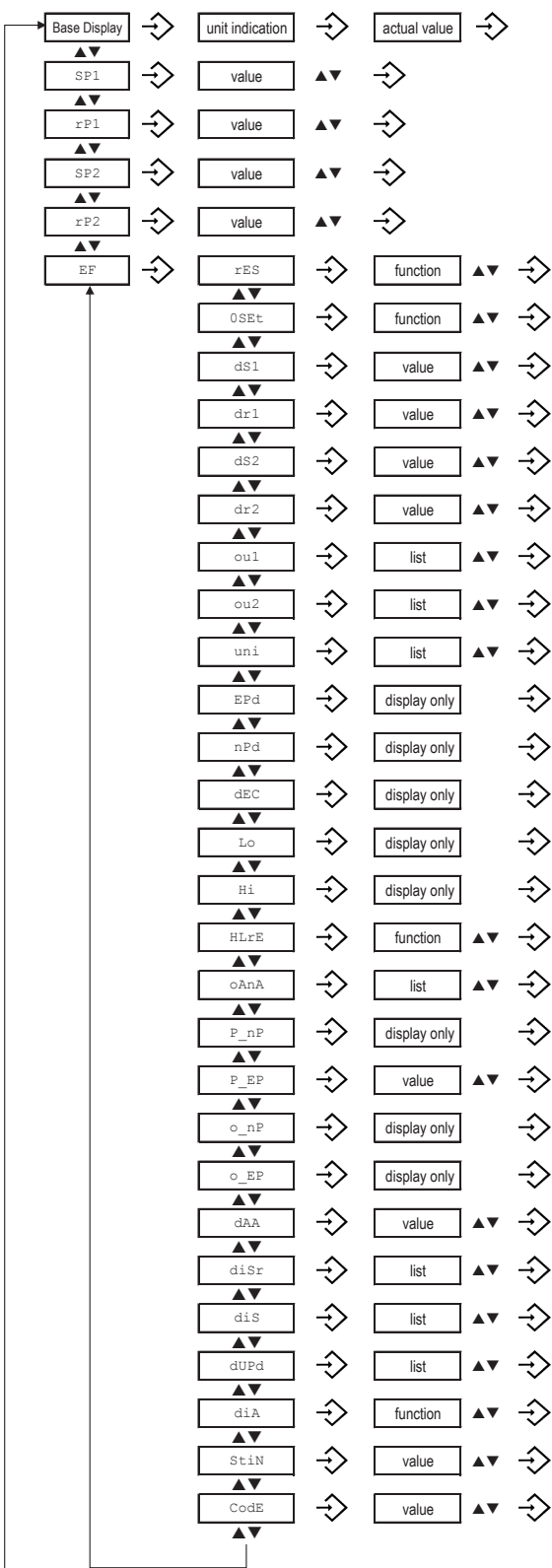

| Description  | Value range  |
|--|--|
| Switch point SP1 (Hysteresis) or Window high FH1               | SP1 > rP1, FH1 > FL1<br>Hysteresis ≥ 1 % FS  |
| Reset point rP1 (Hysteresis) or Window low FL1                 | rP1 < SP1, FL1 < FH1<br>Hysteresis ≥ 1 % FS  |
| Switch point SP2 (Hysteresis) or Window high FH2               | SP2 > rP2, FH2 > FL2<br>Hysteresis ≥ 1 % FS  |
| Reset point rP2 (Hysteresis) or Window low FL2                 | rP2 < SP2, FL2 < FH2<br>Hysteresis ≥ 1 % FS  |
| Reset to factory settings                                      |  |
| Zero set, offset correction <sup>1)</sup>                      | ± 2 % FS   |
| Switching delay time for SP1/FH1                               | 0.01 ... 99.99s  |
| Switching delay time for rP1/FL1                               | 0.01 ... 99.99s  |
| Switching delay time for SP2/FH2                               | 0.01 ... 99.99s  |
| Switching delay time for rP2/FL2                               | 0.01 ... 99.99s  |
| Function switching output 1                                    | Hysteresis NO (Hno), Hysteresis NC (Hnc)<br>Window NO (Fno), Window NC (Fnc)       |
| Function switching output 2                                    | Hysteresis NO (Hno), Hysteresis NC (Hnc)<br>Window NO (Fno), Window NC (Fnc)       |
| Pressure unit  | bar / MPa / kPa / psi / mWC / mmWC /<br>inchWC / % / user scale <sup>1)</sup>      |
| End-point display value (option user scale unit)               | -998 ... 9999 <sup>1)</sup>  |
| Zero-point display value (option user scale unit)              | -999 ... 9998 <sup>1)</sup>  |
| Decimal point (option user scale unit)                         | 0, 1, 2, 3 (value depending)   |
| Lowest measured pressure                                       |  |
| Highest measured pressure                                      |  |
| Reset highest and lowest pressure value                        |  |
| Analogue output type   | I, U, off  |
| Pressure zero-point  | 0 % ... 50 % FS <sup>1) 2)</sup>   |
| Pressure end-point   | 50 % ... 100 % FS <sup>2)</sup>  |
| Analogue output zero-point                                     | Voltage: 0 ... 2 VDC<br>Current loop: 3.9 ... o_EP - 8 mA <sup>1)</sup>            |
| Analogue output end-point                                      | Voltage: o_nP + 4 ... 10.5 VDC<br>Current loop: o_nP + 8 ... 20.1 mA <sup>1)</sup> |
| Damping analogue output rise time 10 ... 90 % nominal pressure | 0.01 ... 3.00 s  |
| Display rotate   | no, yes (180°)   |
| Display mode   | actual, highest, lowest, off,<br>act. - 1 decimal, act. - 2 dec., act. - 3 dec.    |
| Display update rate  | 1, 2, 5, 20 Hz   |
| Diagnostic mode  |  |
| Sampling time for logger                                       | 0.1 ... 999.9 s, off (0)   |
| Access code  | 4-digit code   |

<sup>1)</sup> optional function package  
<sup>2)</sup> P\_EP - P\_nP ≥ 50 % FS

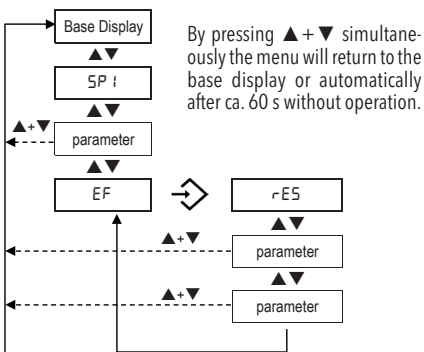

By pressing ▲ + ▼ simultaneously the menu will return to the base display or automatically after ca. 60 s without operation.



pw\* When performing a parameter change by pressing ▲ or ▼ and if an access code has been defined, it has to be entered digit by digit.

After confirming the new parameter value, the menu item of the changed parameter will be displayed.