

INDUSTRIAL PRESSURE TRANSMITTER

Swiss based Trafag is a leading international supplier of high quality sensors and monitoring instruments for measurement of pressure and temperature. The industrial pressure transmitter EPI 8287 features the extremely robust and stable thin-film-on-steel sensor element from its well-proven predecessor EPI 8297. In combination with the new inhouse developed ASIC TX it offers a wide temperature range up to 125°C and triple overpressure safety which makes it the perfect solution for a wide range of demanding applications.



Applications

- Machine tools
- Hydraulics
- Industrial applications

Features

- Excellent long-term stability
- High resistance to over pressure
- Completely welded steel sensor system without additional seals
- Compact design
- Different accuracy classes

Technical Data			
Measuring principle	Thin film on steel	Accuracy @ 25°C typ.	± 0.5 % FS typ. ± 0.3 % FS typ.
Measuring range	0 ... 2.5 to 0 ... 600 bar 0 ... 30 to 0 ... 7500 psi	Media temperature	-40°C ... +125°C
Output signal	4 ... 20 mA, 0 ... 5 VDC, 1 ... 6 VDC, 0 ... 10 VDC, 0.5 ... 4.5 VDC ratiometric	Ambient temperature	-40°C ... +125°C Cable PVC: -5°C ... +60°C Cable PUR: -20°C ... +70°C Cable Raychem: -20°C ... +100°C

08/2017

Data sheet H72317h

Subject to change

Ordering information/type code

				8287 . XX	XX	XX	XX	XX	XX	
Measuring range ¹⁾	Pressure measurement range [bar]	Over pressure [bar]	Burst pressure [bar]							
				Pressure measurement range [psi]	Over pressure [psi]	Burst pressure [psi]				
	0 ... 2.5	7.5	50	75	0 ... 30	90	700	G5		
	0 ... 4	12	60	76	0 ... 50	150	850	G6		
	0 ... 6	18	100	77	0 ... 100	300	1450	G7		
	0 ... 10	30	200	78	0 ... 150	450	2500	G8		
	0 ... 16	48	200	79	0 ... 200	600	2500	GA		
	0 ... 25	75	300	80	0 ... 250	750	2500	G9		
	0 ... 40	120	300	81	0 ... 300	900	4000	HA		
	0 ... 60	180	400	82	0 ... 400	1200	4000	H0		
	0 ... 100	300	500	83	0 ... 500	1500	4000	H1		
	0 ... 160	480	750	85	0 ... 1000	3000	5000	H2		
	0 ... 250	750	1000	74	0 ... 1500	4500	7000	H3		
	0 ... 400	1000	2000	84	0 ... 2000	6000	10000	H5		
	0 ... 600	1500	2500	86	0 ... 3000	9000	14500	G4		
	Option 5P:	Fivefold overpressure			0 ... 5000	12500	21750	H4		
	0 ... 2.5	12.5	60	55	0 ... 7500	18750	29000	H6		
	0 ... 4	20	100	56						
	0 ... 6	30	200	57						
	0 ... 10	50	200	58						
	0 ... 16	80	300	59						
	0 ... 25	125	300	60						
	0 ... 40	200	400	61						
	0 ... 60	300	500	62						
	0 ... 100	500	750	63						
	0 ... 160	800	1000	65						
	Sensor	Relative pressure, accuracy: 0.5 %; Material pressure connection and housing: 1.4542 (AISI630)							25	
		Relative pressure, accuracy: 0.5 %; Material pressure connection and housing: 1.4404 (AISI316L) ^{2) 3) 5)}							35	
		Relative pressure, accuracy: 0.3 %; Material pressure connection and housing: 1.4542 (AISI630)							23	
	Relative pressure, accuracy: 0.3 %; Material pressure connection and housing: 1.4404 (AISI316L) ^{2) 3) 5)}							33		
Pressure connection	G1/4" female ²⁾							10		
	G1/4" male (Seal)							17		
	R1/4" male, DIN3858 ²⁾							19		
	G1/2" male (Manometer) ²⁾							11		
	1/4" NPT male							30		
	1/2" NPT male ²⁾							51		
	M14x1.5 male DIN6149-2 ²⁾							31		
	7/16"-20UNF male, DIN3866 ^{2) 6)}							18		
	7/16"-20UNF male SAE4 (J1926) ^{2) 7)}							42		
	7/16"-20UNF female SAE J512 with valve opener ⁶⁾							24		
Electrical connection	Male electrical plug EN 175301-803-A, Mat. PA							05		
	Male electrical plug M12x1, 5-pole, Mat. PBT							35		
	Male electrical plug Packard Metri Pack, Mat. PBT ⁴⁾							51		
	Male electrical plug industrial standard, contact distance 9.4 mm, Mat. PBT							01		
	Cable PUR, IP68 (Screwed cable gland PA 6-3), -20°C ... +70°C ^{8) 9)}							24		
	Cable PVC, IP68 (Screwed cable gland PA 6-3), -5°C ... +60°C ^{8) 9) 10)}							22		
	Cable Raychem, IP68 (Screwed cable gland PA 6-3), -20°C ... +100°C ^{8) 9) 10)}							08		

Output signal	Signal output	Load resistance	I (supply)	U (supply)	
	4 ... 20 mA	(U _{supply} -9 V) / 20 mA		9 ... 32 VDC	19
	0 ... 5 VDC	> 2.5 kΩ	< 10 mA	9 ... 32 VDC	14
	1 ... 6 VDC	> 5.0 kΩ	< 10 mA	9 ... 32 VDC	16
	0 ... 10 VDC	> 5.0 kΩ	< 10 mA	15 ... 32 VDC	17
	0.5 ... 4.5 VDC ratiometric	> 5.0 kΩ	< 10 mA	5 (4.75 ... 5.25) VDC	23
Accessories	Seal FPM, -18°C ... +125°C ³⁾				61
	Seal EPDM, -40°C ... +125°C ³⁾				63
	Seal NBR, -25°C ... +100°C ³⁾				83
	Pressure peak damping element ø 1.0 mm (for pressure connections 17, 19, 30, 31, 51)				40
	Pressure peak damping element ø 0.4 mm (for pressure connections 17, 19, 30, 31, 51)				44
	Female electrical connector EN 175301-803-A (DIN43650-A)				58
	Female electrical plug M12x1, 5-pole				33
	Female electrical connector industrial standard				34
	Special electrical connection: Pin 1 + , Pin 2 - (only for output signal 4 ... 20 mA and male electrical plug EN175301-803-A / DIN43650-A)				92
	Special electrical connection: Pin 1 Out , Pin 2 - , Pin 3 + (only for output 14, 16, 17 and male electrical plug EN175301-803-A / DIN43650-A)				98
	Special electrical connection: Pin 1 + , Pin 2 - , Pin 3 Out (only for output 14, 16, 17 and male electrical plug EN175301-803-A / DIN43650-A)				97
	Special electrical connection: Pin 1 + , Pin 3 - (only for output 4 ... 20 mA and male electrical plug Packard Metri Pack 3-poles)				E4
	Special electrical connection: Pin 1 + , Pin 2 out Pin 3 - (only for output signals 14, 16, 17 and male electrical plug Packard Metri Pack 3-poles)				99
	Housing nut for electrical connection EN175301-803-A (DIN43650-A) secured with Loctite (max. 85°C)				L9
	Cable length 1.5 m				1M
Cable length 3.0 m				3M	
Cable length 5.0 m				5M	

¹⁾ Customized pressure ranges upon request

²⁾ Upon request

³⁾ Only with pressure connection 17 (G1/4")

⁴⁾ Pressure ranges > 16 bar (Pressure ranges ≤ 16 bar upon request)

⁵⁾ Only for pressure ranges ≥ 10 bar

⁶⁾ Max. allowable pressure range 60 bar at 120 bar overpressure

⁷⁾ According to norm J1926, max. 35 MPa

⁸⁾ Cable length see accessories (max. length 50 m, in 5-meter sections)

⁹⁾ IP68, max. 3 m, Media +10°C ... +35°C

¹⁰⁾ Cable length max. 3 m, for pressure ranges ≤ 16 bar

Standard products (extra short lead time)

Product No.	Type Code	Pressure range [bar]	Over pressure max. [bar]	Signal output	Supply [VDC]
EPI4.0A	8287 76 2517 05 0000 0000 19 44 58 61	0 ... 4	12	4 ... 20 mA	9 ... 32
EPI6.0A	8287 77 2517 05 0000 0000 19 44 58 61	0 ... 6	18	4 ... 20 mA	9 ... 32
EPI10.0A	8287 78 2517 05 0000 0000 19 44 58 61	0 ... 10	30	4 ... 20 mA	9 ... 32
EPI16.0A	8287 79 2517 05 0000 0000 19 44 58 61	0 ... 16	48	4 ... 20 mA	9 ... 32
EPI25.0A	8287 80 2517 05 0000 0000 19 44 58 61	0 ... 25	75	4 ... 20 mA	9 ... 32
EPI40.0A	8287 81 2517 05 0000 0000 19 44 58 61	0 ... 40	120	4 ... 20 mA	9 ... 32
EPI60.0A	8287 82 2517 05 0000 0000 19 44 58 61	0 ... 60	180	4 ... 20 mA	9 ... 32
EPI100.0A	8287 83 2517 05 0000 0000 19 44 58 61	0 ... 100	300	4 ... 20 mA	9 ... 32
EPI250.0A	8287 74 2517 05 0000 0000 19 44 58 61	0 ... 250	750	4 ... 20 mA	9 ... 32
EPI400.0A	8287 84 2517 05 0000 0000 19 44 58 61	0 ... 400	1000	4 ... 20 mA	9 ... 32
EPI600.0A	8287 86 2517 05 0000 0000 19 44 58 61	0 ... 600	1500	4 ... 20 mA	9 ... 32
EPI4.0V	8287 76 2517 05 0000 0000 17 44 58 61	0 ... 4	12	0 ... 10 VDC	15 ... 32
EPI6.0V	8287 77 2517 05 0000 0000 17 44 58 61	0 ... 6	18	0 ... 10 VDC	15 ... 32
EPI10.0V	8287 78 2517 05 0000 0000 17 44 58 61	0 ... 10	30	0 ... 10 VDC	15 ... 32
EPI16.0V	8287 79 2517 05 0000 0000 17 44 58 61	0 ... 16	48	0 ... 10 VDC	15 ... 32
EPI25.0V	8287 80 2517 05 0000 0000 17 44 58 61	0 ... 25	75	0 ... 10 VDC	15 ... 32
EPI40.0V	8287 81 2517 05 0000 0000 17 44 58 61	0 ... 40	120	0 ... 10 VDC	15 ... 32
EPI60.0V	8287 82 2517 05 0000 0000 17 44 58 61	0 ... 60	180	0 ... 10 VDC	15 ... 32
EPI100.0V	8287 83 2517 05 0000 0000 17 44 58 61	0 ... 100	300	0 ... 10 VDC	15 ... 32
EPI250.0V	8287 74 2517 05 0000 0000 17 44 58 61	0 ... 250	750	0 ... 10 VDC	15 ... 32
EPI400.0V	8287 84 2517 05 0000 0000 17 44 58 61	0 ... 400	1000	0 ... 10 VDC	15 ... 32
EPI600.0V	8287 86 2517 05 0000 0000 17 44 58 61	0 ... 600	1500	0 ... 10 VDC	15 ... 32

Specifications		
Electrical Data	Output / supply voltage	4 ... 20 mA: 24 (9...32) VDC 0 ... 5 VDC: 24 (9...32) VDC 1 ... 6 VDC: 24 (9...32) VDC 0 ... 10 VDC: 24 (15...32) VDC 0.5 ... 4.5 VDC ratiometric 10 ... 90 % U_{supply} : 5 ± 0.25 VDC
	Rise time	Typ. 1 ms / 10 ... 90 % nominal pressure
	Switch-on-delay	100 ms
	Inverse-polarity protection, short-circuit strength @ 25°C during 5 min.	4 ... 20 mA: to $U_s = 32$ VDC 0 ... 10 VDC, 0 ... 5 VDC, 1 ... 6 VDC: to $U_s = 28$ VDC 0.5 ... 4.5 VDC ratiometric: to $U_s = 14$ VDC
	Environmental conditions	
	Media temperature	-40°C ... +125°C
	Ambient temperature	-40°C ... +125°C Cable PVC: -5°C ... +60°C Cable PUR: -20°C ... +70°C Cable Raychem: -20°C ... +100°C
	Protection ¹⁾	IP65, IP67, IP68
	Humidity	Max. 95 % relative
	Vibration	15 g RMS (20...2000 Hz) acc.to EN 60068-2-64 25 g sin (80...2000 Hz), 1 oct./min, (1x @ 25°C) acc.to EN 60068-2-6
	Shock	500 g / 1 ms acc.to EN 60068-2-27
EMC Protection	Emission	EN/IEC 61000-6-3
	Immunity	EN/IEC 61000-6-2
Mechanical Data	Sensor (wetted parts)	1.4542 (AISI630)
	Pressure connection (wetted parts)	1.4542 (AISI630) or 1.4404 (AISI316L)
	Housing	1.4542 (AISI630) or 1.4404 (AISI316L)
	Sealing	FPM/EPDM/NBR
	Male electrical plug	See ordering information
	Weight	appr. 80 ... 110 g
	Mounting torque	25 Nm

¹⁾ See electrical connection

Accuracy

		Measuring accuracy 0.5 % Ordering No. 25/35	Measuring accuracy 0.3 % Ordering No. 23/33
TEB @ -25 ... +85°C	[% FS typ.]	± 1.75	± 1.0
Accuracy @ +25°C	[% FS typ.]	± 0.5	± 0.3
NLH @ +25°C (BSL)	[% FS typ.]	± 0.2	± 0.2
TC zero point and span	[% FS/K typ.]	± 0.03	± 0.01
Long term stability 1 year @ +25°C	[% FS typ.]	± 0.1	± 0.2

Measuring accuracy 0.5 %

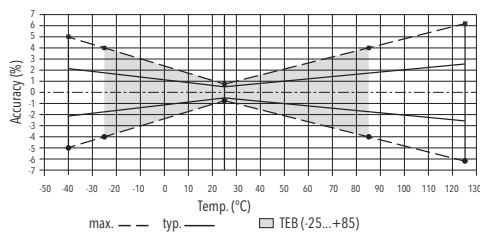

Measuring accuracy 0.3 %

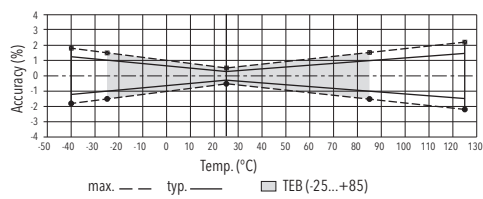

Dimensions

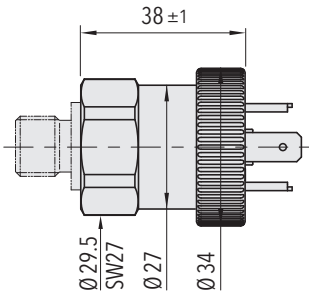

8287.XX.XXXX.05.XX.XX

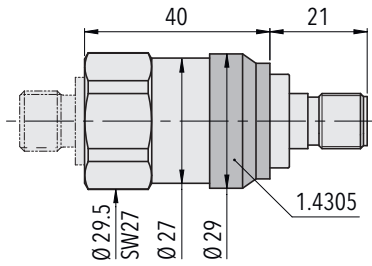

8287.XX.XXXX.35.XX.XX

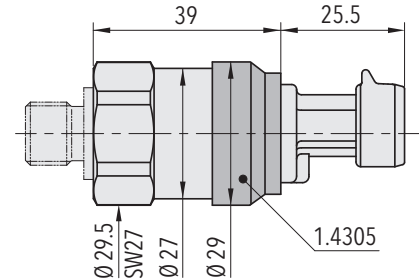

8287.XX.XXXX.51.XX.XX

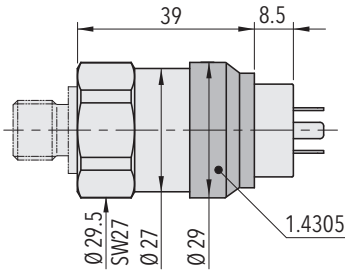

8287.XX.XXXX.01.XX.XX

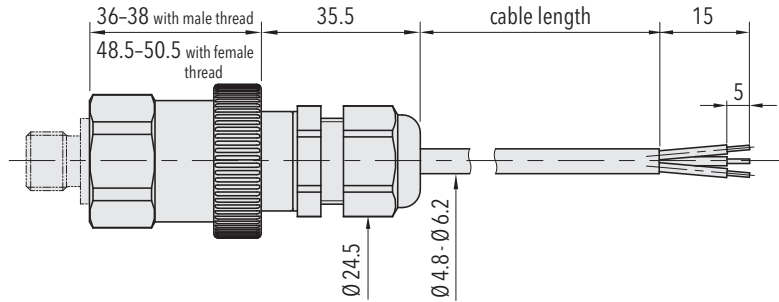

8287.XX.XXXX.24/22/08.XX.XX

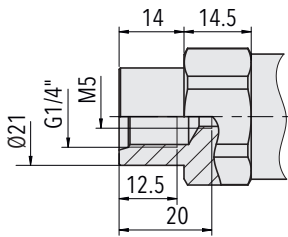

8287.XX.XX10.XX.XX.XX

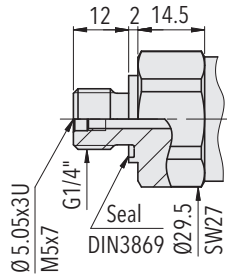

8287.XX.XX17.XX.XX.XX

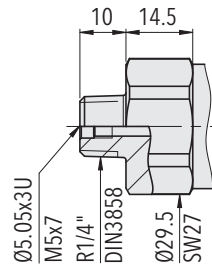

8287.XX.XX19.XX.XX.XX

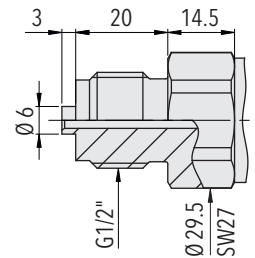

8287.XX.XX11.XX.XX.XX

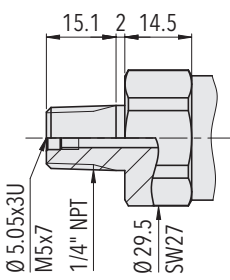

8287.XX.XX30.XX.XX.XX

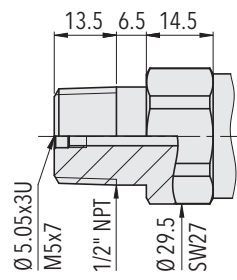

8287.XX.XX51.XX.XX.XX

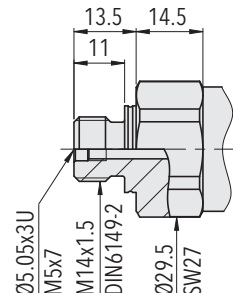

8287.XX.XX31.XX.XX.XX

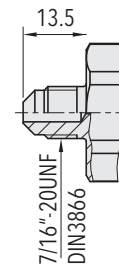

8287.XX.XX18.XX.XX.XX

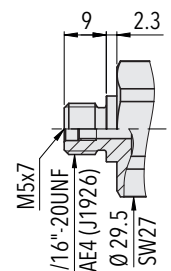

8287.XX.XX42.XX.XX.XX

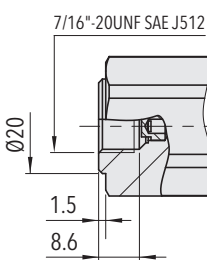

8287.XX.XX24.XX.XX.XX

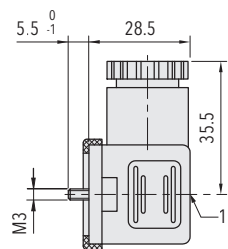

1) Tightening torque 50...60Ncm

8287.XX.XXXX.XX.XX.58

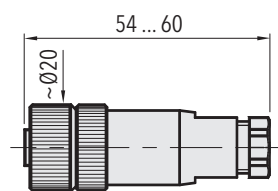

8287.XX.XXXX.XX.XX.33

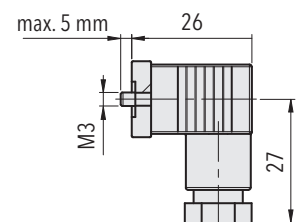

8287.XX.XXXX.XX.XX.34

Electrical connection

		Protection / electrical connection							
		IP65*)	IP67*)	IP67*)	IP65	IP68 max. 3 m	IP68 max. 3 m		
		Industrial standard EN175301-803A**)	M12x1 **) 5-pole	Packard Metri Pack **) 3-pole	Industrial standard Contact distance 9.4 mm **)	Cable**)	Cable**)		
		05	35	51	01	24/22	08		
Output signal	<p>8287.XX.XXXX.XX.19</p>	Standard	92		E4				
	<p>8287.XX.XXXX.XX.14/16/17/23</p>	Standard	98	97	99				
		2	1	4	1	1	2	white	red
		1	2	1	2	3	1	brown	black
		⊕	⊕	5	⊕	⊕	⊕	yellow	green
		2	3	2	1	1	1	white	red
		3	1	4	3	2	2	green	white
		1	2	3	2	3	3	brown	black
		⊕	⊕	5	⊕	⊕	⊕	yellow	green

*) Provided female connector is mounted according to instructions

**) Ventilation via male electric plug/cable end

***) Only cable versions or female electrical plug with shield connection

Additional information

Documents

Data sheet	www.trafag.com/H72317
Instructions	www.trafag.com/H73317
Flyer	www.trafag.com/H70692