

PRESSURE TRANSMITTER

Swiss based Trafag is a leading international supplier of high quality sensors and monitoring instruments for measurement of pressure and temperature.



Applications

- Test benches
- Railways
- Machine tools
- Hydraulics
- Process technology

Features

- Smallest design
- Accuracy classes 0.1 %, 0.15 %, 0.3 %
- Excellent temperature resistance
- Relative and absolute pressure measurement
- Optional: Dielectrical strength 500 VAC, meets EN 50155 (Railways)

| Technical Data | | | |
|-----------------------|---|----------------------|--|
| Measuring principle | Thin-film-on-steel | Accuracy @ 25°C typ. | ± 0.3 % FS typ. ± 0.15 % FS typ. ± 0.1 % FS typ. |
| Measuring range | 0 ... 2.5 to 0 ... 600 bar 0 ... 30 to 0 ... 7500 psi | Media temperature | -40°C ... +125°C |
| Output signal | 4 ... 20 mA, 0 ... 5 VDC, 1 ... 6 VDC, 0 ... 10 VDC, 0.5 ... 4.5 VDC ratiometric | Ambient temperature | -40°C ... +125°C |
| NLH @ 25°C (BSL) typ. | ± 0.2 % FS typ. ± 0.1 % FS typ. | | |

01/2021

Data sheet H72300w

Subject to change

Ordering information/type code

| | | | | 8253 . XX | | | | XX | XX | XX | XX | XX |
|--------------------------------------|--|------------------------------------|-----------------------------|---|----------------------------|-----------------------------|-----------|-----------|----|----|----|----|
| Measuring range ¹⁾ | Pressure measurement range [bar] | Over pressure [bar] | Burst pressure [bar] | Pressure measurement range [psi] | Over pressure [psi] | Burst pressure [psi] | | | | | | |
| | 0 ... 2.5 ²⁾ | 5 | 50 | 0 ... 30 | 60 | 700 | G5 | | | | | |
| | 0 ... 4 | 8 | 60 | 0 ... 50 | 100 | 850 | G6 | | | | | |
| | 0 ... 6 | 12 | 100 | 0 ... 100 | 200 | 1450 | G7 | | | | | |
| | 0 ... 10 | 20 | 200 | 0 ... 150 | 300 | 2500 | G8 | | | | | |
| | 0 ... 16 | 32 | 200 | 0 ... 200 | 400 | 2500 | GA | | | | | |
| | 0 ... 25 | 50 | 300 | 0 ... 250 | 500 | 2500 | G9 | | | | | |
| | 0 ... 40 | 80 | 300 | 0 ... 300 | 600 | 4000 | HA | | | | | |
| | 0 ... 60 | 120 | 400 | 0 ... 400 | 800 | 4000 | H0 | | | | | |
| | 0 ... 100 | 200 | 500 | 0 ... 500 | 1000 | 4000 | H1 | | | | | |
| | 0 ... 160 | 320 | 750 | 0 ... 1000 | 2000 | 5000 | H2 | | | | | |
| | 0 ... 250 | 500 | 1000 | 0 ... 1500 | 3000 | 7000 | H3 | | | | | |
| | 0 ... 400 | 800 | 1500 | 0 ... 2000 | 4000 | 10000 | H5 | | | | | |
| | 0 ... 600 | 1000 | 2000 | 0 ... 3000 | 6000 | 14500 | G4 | | | | | |
| | | | | 0 ... 5000 | 10000 | 21750 | H4 | | | | | |
| | | | | 0 ... 7500 | 15000 | 29000 | H6 | | | | | |
| Sensor | Relative pressure, accuracy: 0.3 % | | | | | | 23 | | | | | |
| | Relative pressure, accuracy: 0.15 % | | | | | | 21 | | | | | |
| | Relative pressure, accuracy: 0.1 % | | | | | | 24 | | | | | |
| | Absolute pressure, accuracy: 0.3 % ⁴⁾ | | | | | | 43 | | | | | |
| | Absolute pressure, accuracy: 0.15 % ⁴⁾ | | | | | | 41 | | | | | |
| | Absolute pressure, accuracy: 0.1 % ⁴⁾ | | | | | | 44 | | | | | |
| Pressure connection | G1/4" male (Seal) | | | | | | | 17 | | | | |
| | 1/4" NPT male | | | | | | | 30 | | | | |
| | 1/4" NPT female ⁷⁾ | | | | | | | 13 | | | | |
| | 7/16"-20UNF male ^{3) 4)} | | | | | | | 18 | | | | |
| | 7/16"-20UNF female, DIN3866 (valve opener) ^{3) 4)} | | | | | | | 24 | | | | |
| | 7/16"-20UNF male, SAE4 (J1926) | | | | | | | 42 | | | | |
| | 9/16"-18UNF male, SAE6 (J1926), seal: accessory 61 ^{3) 7)} | | | | | | | 61 | | | | |
| | 3/8"-24UNF SAE3 male (J514) ^{3) 7)} | | | | | | | 66 | | | | |
| | R1/4" male, DIN2999 ^{3) 7)} | | | | | | | 20 | | | | |
| | M14x1.5 male DIN EN ISO 6149-2 ^{3) 7)} | | | | | | | 31 | | | | |
| Electrical connection | Male electrical connector, industrial standard (contact distance 9.4 mm), Mat. PBT | | | | | | | 01 | | | | |
| | Male electrical connector M12x1, 4-pole, Mat. PBT | | | | | | | 32 | | | | |
| | Male electrical connector M12x1, 5-pole, Mat. PBT | | | | | | | 35 | | | | |
| | Male electrical connector MIL-C 26482, 6-pole, metal | | | | | | | 02 | | | | |
| | Cable Mat. EPD Raychem FDR25, IP67, 4 x 0.2 mm ² ⁷⁾ | | | | | | | 08 | | | | |
| Output signal | Signal output | Load resistance | I (supply) | U (supply) | | | | | | | | |
| | 4 ... 20 mA | (U _{supply} -9 V) / 20 mA | | 24 (9 ... 32) VDC | | 19 | | | | | | |
| | 0 ... 5 VDC | ≥ 2.0 kΩ | ≤ 10 mA | 24 (9 ... 32) VDC | | 14 | | | | | | |
| | 1 ... 6 VDC | ≥ 2.0 kΩ | ≤ 10 mA | 24 (9 ... 32) VDC | | 16 | | | | | | |
| | 0 ... 10 VDC | ≥ 5.0 kΩ | ≤ 10 mA | 24 (15 ... 32) VDC | | 17 | | | | | | |
| | 0.5 ... 4.5 VDC | ≥ 2.0 kΩ | ≤ 10 mA | 5 (4.5 ... 5.5) VDC ratiom. | | 23 | | | | | | |

| Accessories | | |
|--|--|----|
| Female electrical plug M12x1, 5-pole, for electrical connections 32 and 35 | | 33 |
| Female electrical plug industrial standard | | 34 |
| Meets EN 50155 (railways) dielectrical strength: 500 VAC, 50 Hz ⁵⁾ | | 11 |
| Pressure peak damping element ø 1.0 mm ⁶⁾ | | 40 |
| Pressure peak damping element ø 0.3 mm ⁶⁾ | | 43 |
| Pressure peak damping element ø 0.5 mm ⁶⁾ | | 45 |
| Special electrical connection: Pin 1 +, Pin 2 Ground, Pin 3 -, Pin 4 Out (only for output signals 14, 16, 17, 23 and male electrical connector 32, M12x1, 4-pole) | | 96 |
| Special electrical connection: Pin A +, Pin C Out, Pin B/D -, Pin E Ground (Pin B and D are connected) (only for output signals 14, 16, 17, 23 and male electrical connector MIL-C 26482) | | F3 |
| Cable length 0.5 m | | EM |
| Cable length 1.0 m | | 1M |
| Cable length 2.0 m | | 2M |

¹⁾ Extended overpressure as well as customized pressure ranges upon request

²⁾ Measuring accuracy 0.3 %

³⁾ Only for relative pressure

⁴⁾ Max. allowable pressure range 40 bar

⁵⁾ Only with output 19

⁶⁾ Only for pressure connections 17, 20, 30, 31, 42 and 61

⁷⁾ Upon request



Identical construction with higher/lower specifications: Data sheet No. H72250, H72301

Dimensions

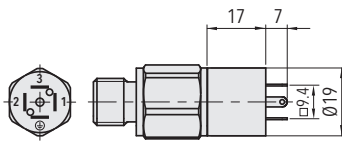

8253.XX.XXXX.01.XX.XX

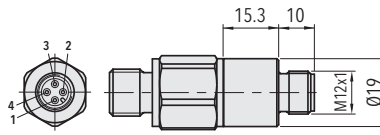

8253.XX.XXXX.32.XX.XX

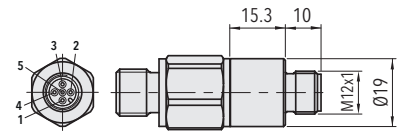

8253.XX.XXXX.35.XX.XX

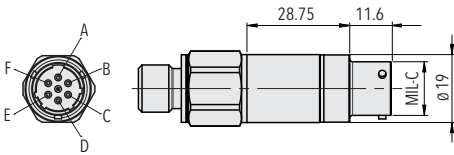

8253.XX.XXXX.02.XX.XX

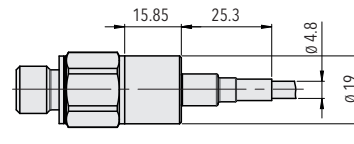

8253.XX.XXXX.08.XX.XX

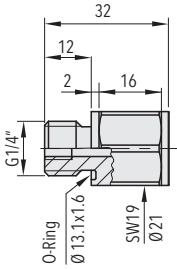

8253.XX.2317.XX.XX.XX

8253.XX.2117.XX.XX.XX

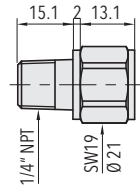

8253.XX.2330.XX.XX.XX

8253.XX.2130.XX.XX.XX

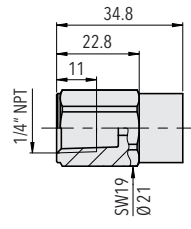

8253.XX.2313.XX.XX.XX

8253.XX.2113.XX.XX.XX

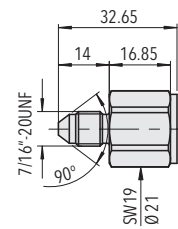

8253.XX.2318.XX.XX.XX

8253.XX.2118.XX.XX.XX

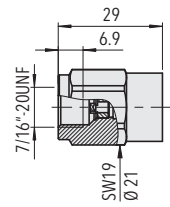

8253.XX.2324.XX.XX.XX

8253.XX.2124.XX.XX.XX

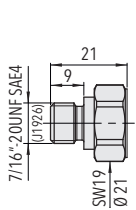

8253.XX.XX42.XX.XX.XX

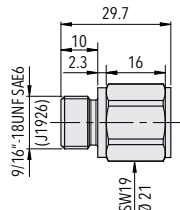

8253.XX.2361.XX.XX.XX

8253.XX.2161.XX.XX.XX

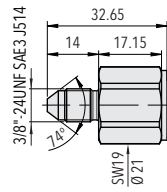

8253.XX.2366.XX.XX.XX

8253.XX.2166.XX.XX.XX

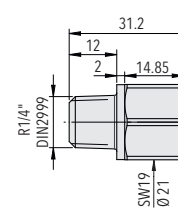

8253.XX.2320.XX.XX.XX

8253.XX.2120.XX.XX.XX

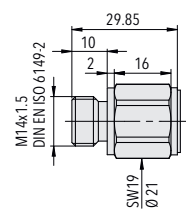

8253.XX.2331.XX.XX.XX

8253.XX.2131.XX.XX.XX

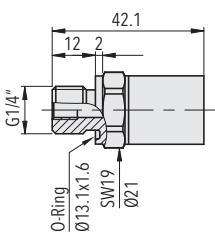

8253.XX.4317.XX.XX.XX

8253.XX.4117.XX.XX.XX

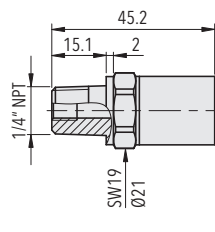

8253.XX.4330.XX.XX.XX

8253.XX.4130.XX.XX.XX

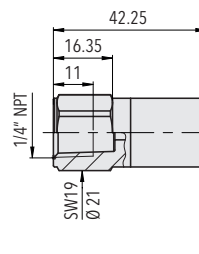

8253.XX.4313.XX.XX.XX

8253.XX.4113.XX.XX.XX

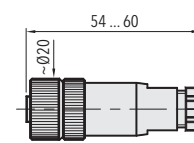

8253.XX.XXXX.XX.XX.33

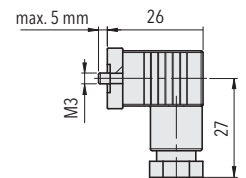

8253.XX.XXXX.XX.XX.34

| Specifications | | |
|---------------------------------|------------------------------------|--|
| Electrical Data | Output / supply voltage | 4 ... 20 mA: 24 (9 ... 32) VDC 0 ... 5 VDC: 24 (9 ... 32) VDC 1 ... 6 VDC: 24 (9 ... 32) VDC 0 ... 10 VDC: 24 (15 ... 32) VDC 0.5 ... 4.5 VDC: 5 VDC ratiom. |
| | Rise time | Typ. 1 ms / 10 ... 90 % nominal pressure |
| | Power-on delay time | 1 s |
| Environmental conditions | Media temperature | -40°C ... +125°C |
| | Ambient temperature | -40°C ... +125°C |
| | Protection ¹⁾ | Min. IP65 |
| | Humidity | Max. 95 % relative |
| | Vibration | 40 g (20...2000 Hz) |
| | Shock | 100 g / 11 ms |
| EMC Protection | Emission | EN/IEC 61000-6-3 |
| | Immunity | EN/IEC 61000-6-2 |
| Mechanical Data | Sensor (wetted parts) | 1.4542 (AISI630) |
| | Pressure connection (wetted parts) | Pressure ranges ≤ 250 bar: 1.4542 (AISI630) Pressure ranges > 250 bar: 1.4301 (AISI304) |
| | Housing | 1.4301 (AISI304) |
| | Sealing | FKM 70 Sh |
| | Male electrical connector | See ordering information |
| | Weight | ~ 50 g |
| | Mounting torque | 25 Nm |

¹⁾ See electrical connection

| Accuracy | | | | |
|--|---------------|---|--|---|
| | | Measuring accuracy 0.3 % Ordering No. 23/43 | Measuring accuracy 0.15 % Ordering No. 21/41 | Measuring accuracy 0.1 % Ordering No. 24/44 |
| TEB @ -25...+85°C | [% FS typ.] | ± 1.0 | ± 0.5 | ± 0.4 (0 ... 65°C) |
| TEB @ -25...+85°C; 0...4 to 0...100 bar | [% FS typ.] | - | - | ± 0.4 |
| TEB @ 0...+65°C; 0...4 to 0...100 bar | [% FS typ.] | - | - | ± 0.25 |
| Accuracy @ +25°C | [% FS typ.] | ± 0.3 | ± 0.15 | ± 0.1 |
| NLH @ +25°C (BSL) | [% FS typ.] | ± 0.2 | ± 0.1 | ± 0.1 |
| TC zero point and span | [% FS/K typ.] | ± 0.01 | ± 0.002 | ± 0.002 |
| Long term stability 1 year @ +25°C | [% FS typ.] | < ± 0.1 | < ± 0.1 | < ± 0.1 |

Measuring accuracy 0.3 %

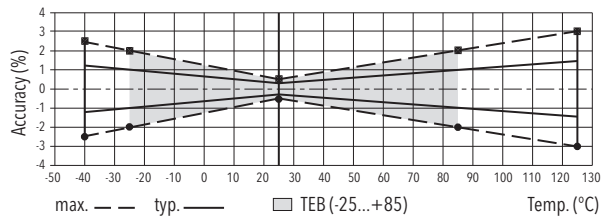

Measuring accuracy 0.15 %

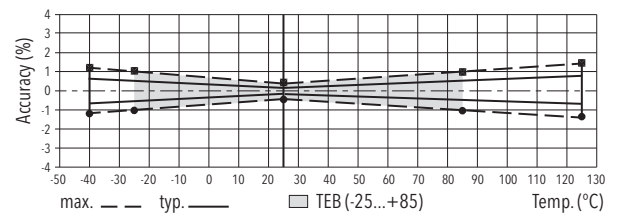

Electrical connection

| | | Protection / electrical connection | | | | |
|---------------|---|--------------------------------------|---------------------|---------------------|----------------|-----------|
| | | IP65 *) | IP67 *) | | IP67 *) **) | IP67 **) |
| | | Industrial standard EN175301-803A | M12x1 | | MIL-C 26482 | Cable |
| | | 01 | 4-pole 32 | 5-pole 35 | 02 | 08 |
| | | | | | | |
| Output signal | <p>8253.XX.XXXX.XX.19</p> | 2 | 1 | 4 | | red |
| | <p>8253.XX.XXXX.XX.14/16/17/23</p> | 1 | 3 | 1 | | black |
| | | ⊕ | 4 | 5 | | - |
| | | | | 96 | | F3 |
| | | 1 | 1 | 1 | A | A |
| | | 2 | 2 | 4 | B | C |
| | | 3 | 3 | 3 | C/D | B/D |
| | | ⊕ | 4 | 2 | E | E |
| | | | | | | red |
| | | | | | | green |
| | | | | | | black |
| | | | | | | - |

*) Provided female electric plug is mounted according to instructions

**) Ventilation via male electric plug/cable end

Additional information

Documents

| | |
|--------------|--|
| Data sheet | www.trafag.com/H72300 |
| Instructions | www.trafag.com/H73250 |
| Flyer | www.trafag.com/H70670 |